

Encore Manual Spray Gun Trigger Replacement



WARNING: Power the gun controller OFF and ground the electrode before performing this procedure. Failure to observe this warning could result in unintended powder flow and electrostatic shock.

Overview

See Figure 1. The snap fit retention feature of the spray trigger and trigger axle has been redesigned for improved durability. The new design has a solid trigger axle. See Figure 1 for a description of the old and new designs.

NOTE: The spray trigger and trigger axle are not interchangeable between the two designs. The new trigger axle will not assemble to the old spray trigger design, requiring both the spray trigger and trigger axle to be replaced (kit 1606999).

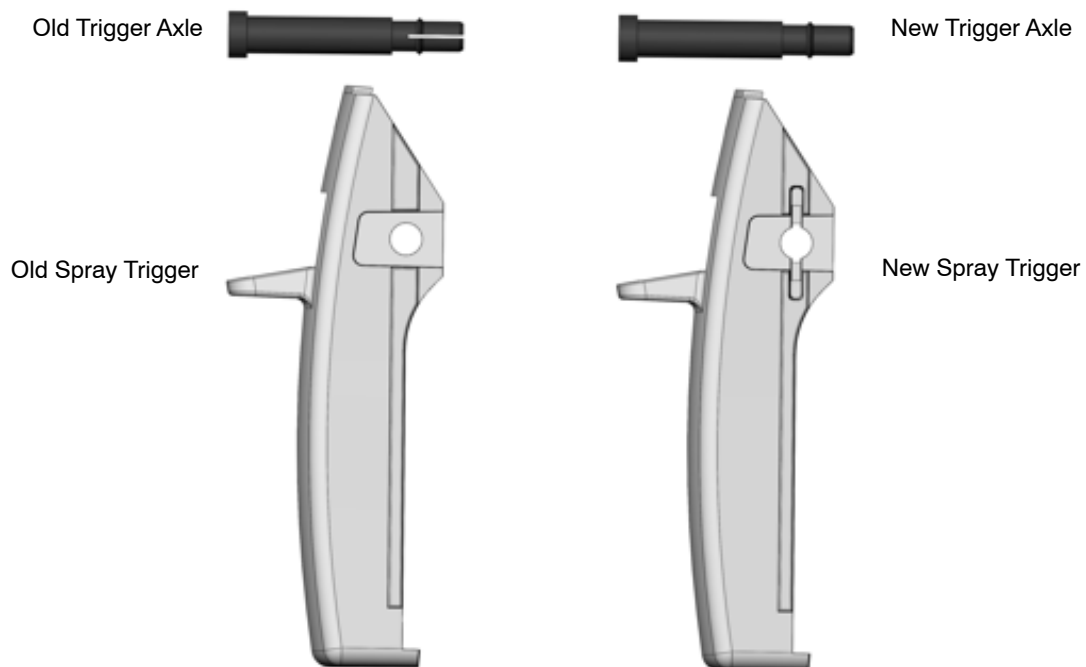

Figure 1 Spray Trigger and Trigger Axle Comparison

Disassembly

See Figure 2.

1. Place the spray gun on a solid surface so the small diameter end of the trigger axle (2) is oriented upward.
2. Using a small, flat-ended punch or 3-mm hex Allen key (1), apply light downward pressure to the small diameter end of the trigger axle (2). Lightly tap the tool to remove the trigger axle (2).

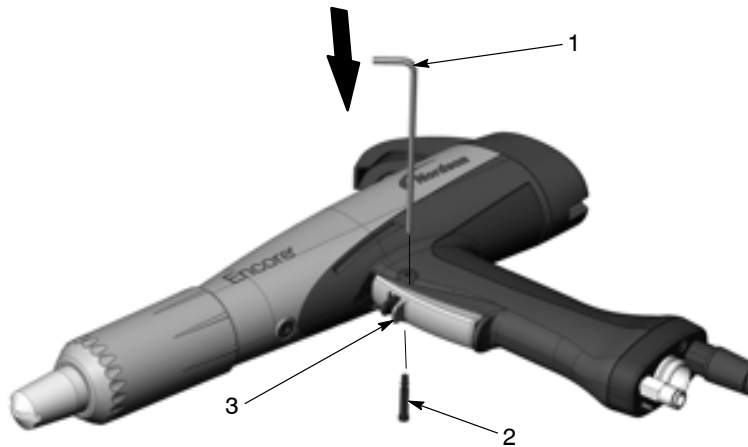

Figure 2 Removing the Trigger Axle

3. See Figure 3. Remove the spray trigger (3), actuator (5), and purge trigger (4) from the handle. Discard the old trigger axle (2) and spray trigger (3). Save the purge trigger (4) for reassembly.

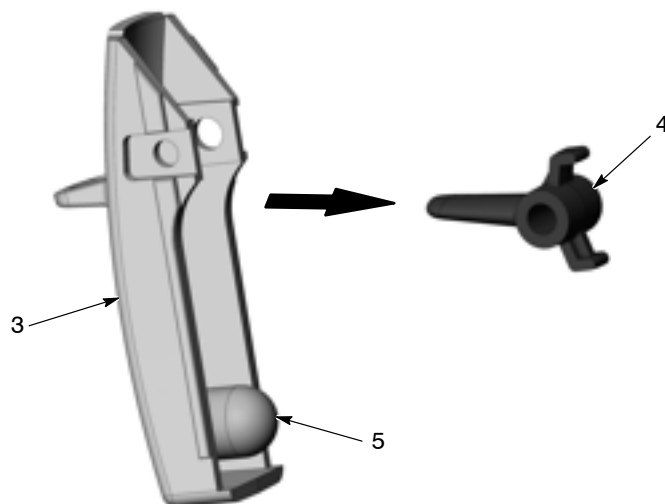

Figure 3 Removing the Trigger Assembly

Reassembly

Reassemble Trigger Assembly

See Figure 4.

4. Install the purge trigger (4) into the new spray trigger (3) with the gusset (6) oriented upward. Do not install the purge trigger (4) upside down.
5. Install the new actuator (5) over the post in the new spray trigger.

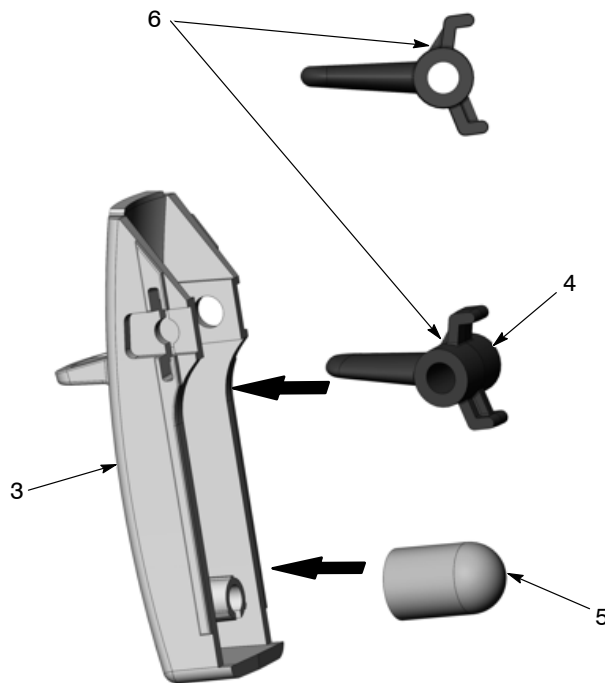

Figure 4 Installing Purge Trigger and Actuator

Install New Trigger Axle

See Figure 5.

- 6. Place the spray gun on a solid surface.
- 7. Position the purge trigger (4) and spray trigger (3) in the spray gun handle and hold them in place while pressing the new trigger axle (2) through the handle and triggers until the head of the trigger axle (2) is installed. The trigger axle (2) will snap into place when properly installed.

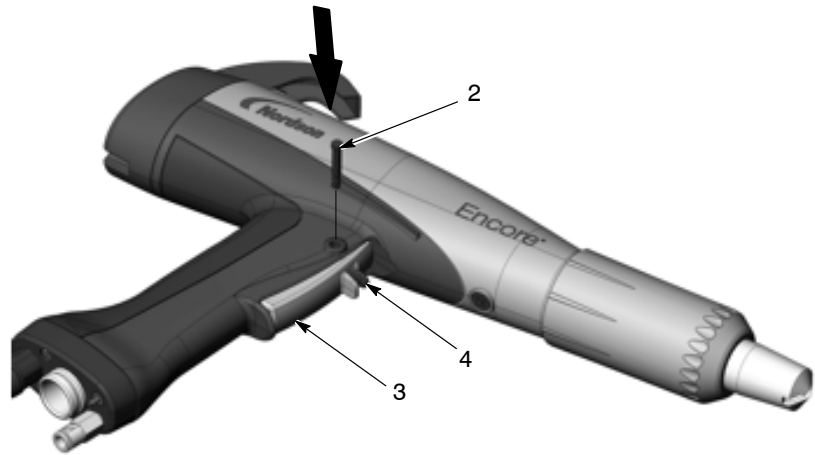

Figure 5 Inserting New Trigger Axle

Parts

Part	Description	Note
1606999	KIT, service, Encore trigger axle/trigger	
-----	• TRIGGER, main, spray gun, Encore, Gen 2	
-----	• AXLE, trigger, solid, spray gun, Encore	
1106892	• ACTUATOR, switch, trigger, Encore LT/XT	

Issued 05/15

Original copyright date 2015. Nordson and the Nordson logo are registered trademarks of Nordson Corporation.

All other trademarks are the property of their respective owners.