

# Sure Coat<sup>®</sup>/Encore<sup>®</sup> Automatic Gun Mounting Assemblies

## Description

This instruction sheet provides a parts list for the mounting assembly used with Sure Coat<sup>®</sup> and Encore<sup>®</sup> automatic powder spray guns. The mounting assembly provides a stable and versatile system for gun mounting and is adjustable for a variety of gun positions and booth depths.

**NOTE:** Refer to the *Installation* section of the Sure Coat and Encore automatic spray gun manuals for mounting assembly installation instructions.

See Figure 1.

The automatic guns slides into the sleeve (3). The adjustable clamp (2) attaches onto a gun stand, oscillator, or reciprocator. The handle (1) and screw (4) allow for positioning of the gun.

## Parts

To order parts, call the Nordson Finishing Customer Support Center at (800) 433-9319 or contact your local Nordson representative.

## Tube-Mount Gun Mounting Assemblies

All mounting assemblies are optional.

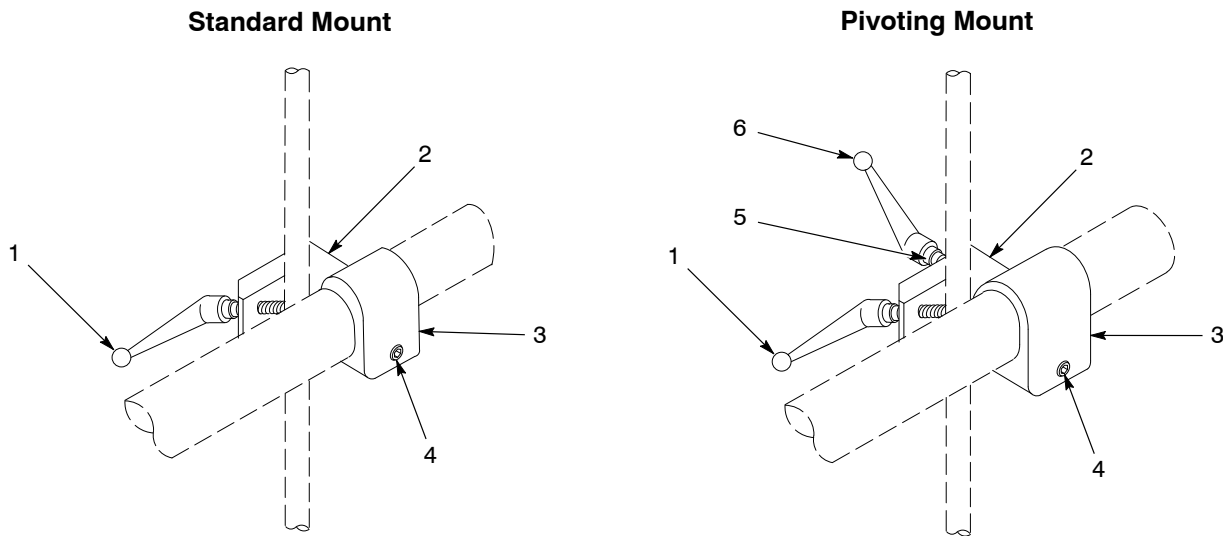

Figure 1 Gun Bar Mounts for Tube-Mount Guns

### Standard Mount Assembly

Item	Part	Description	Quantity	Note
—	1010717	MOUNT, assembly, Sure Coat automatic gun	1	
1	248957	• HANDLE, adjustment, $\frac{3}{8}$ -16 x 1.77 in.	1	
2	-----	• MOUNT, clamp, automatic gun	1	
3	-----	• MOUNT, sleeve, automatic gun	1	
4	981561	• SCREW, socket, $\frac{3}{8}$ -16 x 1.00 in., zinc	3	

### Pivot Mount Assembly

Item	Part	Description	Quantity	Note
—	341756	MOUNT, tube holder, assembly	1	
1	248957	• HANDLE, adjustment, $\frac{3}{8}$ -16 x 1.77 in.	1	
2	-----	• MOUNT, clamp, automatic gun	1	
3	-----	• MOUNT, sleeve, automatic gun	1	
4	981561	• SCREW, socket, $\frac{3}{8}$ -16 x 1.00 in., zinc	3	
5	983061	• WASHER, flat, 0.406 x 0.812 x 0.065 in., zinc	1	
6	249074	• HANDLE, adjustment, $\frac{3}{8}$ -16 x 2.75 in.	1	

## Bar-Mount Gun Mounting Assemblies

### 3-ft Gun Bar Assembly

See Figure 2.

Item	Part	Description	Quantity	Note
—	341726	3-ft GUN BAR, aluminum, 1.25-in. OD, assembly	1	
1	248669	• BODY, adjustable mounting	1	
2	327733	• SLEEVE, locking, 1.25-in. diameter	1	
3	-----	• CAP, plug	1	
4	327732	• BODY, locking, 1.25-in. diameter	1	
5	327703	• ROD, adjusting, aluminum, 1.25-in. OD x 3 ft	1	
6	248957	• HANDLE, adjustment, $\frac{3}{8}$ -16 x 1.77 in.	1	
7	983061	• WASHER, flat, e, 0.406 x 0.812 x 0.065 in., zinc	1	
8	249074	• HANDLE, adjustment, $\frac{3}{8}$ -16 x 2.75 in.	1	

### 4-ft Gun Bar Assembly

See Figure 2.

Item	Part	Description	Quantity	Note
—	341727	4-ft GUN BAR, aluminum, 1.25-in. OD, assembly	1	
1	248669	• BODY, adjustable mounting	1	
2	327733	• SLEEVE, locking, 1.25-in. diameter	1	
3	-----	• CAP, plug	1	
4	327732	• BODY, locking, 1.25-in. diameter	1	
5	327704	• ROD, adjusting, aluminum, 1.25-in. OD x 4 ft	1	
6	248957	• HANDLE, adjustment, $\frac{3}{8}$ -16 x 1.77 in.	1	
7	983061	• WASHER, flat, e, 0.406 x 0.812 x 0.065 in., zinc	1	
8	249074	• HANDLE, adjustment, $\frac{3}{8}$ -16 x 2.75 in.	1	

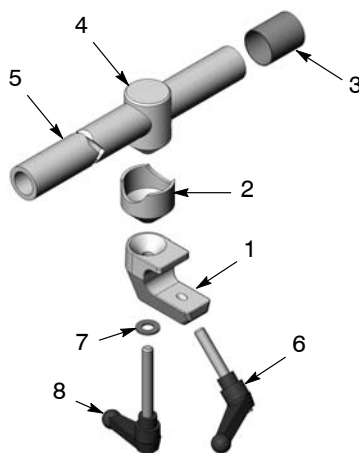

Figure 2 Gun Bar Mounts for Tube-Mount Guns

Issued 01/15

Original copyright date 2015. Nordson, the Nordson logo, Encore, and Sure Coat are registered trademarks of Nordson Corporation.