

# Encore® Automatic Porcelain Enamel Powder Spray Gun



## 1601417 Bar-Mount Spray Gun

Refer to Encore Automatic Porcelain Enamel Powder Spray Gun Manual P/N 1601753 for complete parts and service information.

### AVAILABLE OPTIONS

#### Mounting Bar Kits:

- 341727 Articulating, 4 ft., standard
- 1601743 Articulating, 4 ft., large ID\*
- 1104067 Fixed, 4 ft., standard
- 1601742 Fixed, 4 ft., large ID\*

\* Powder hose, cable, and air tubing can be routed through large ID mounting bars.

#### Gun Cables:

- 1097537 Cable, 8 meter
- 1097539 Cable, 12 meter
- 1097540 Cable, 16 meter
- 1601344 Cable extension, 4 meter

#### Other Options:

- 1602227 Ion collector kit

#### Application Specific:

- ▲ 1609053 Positive power supply (sold separately from gun body)

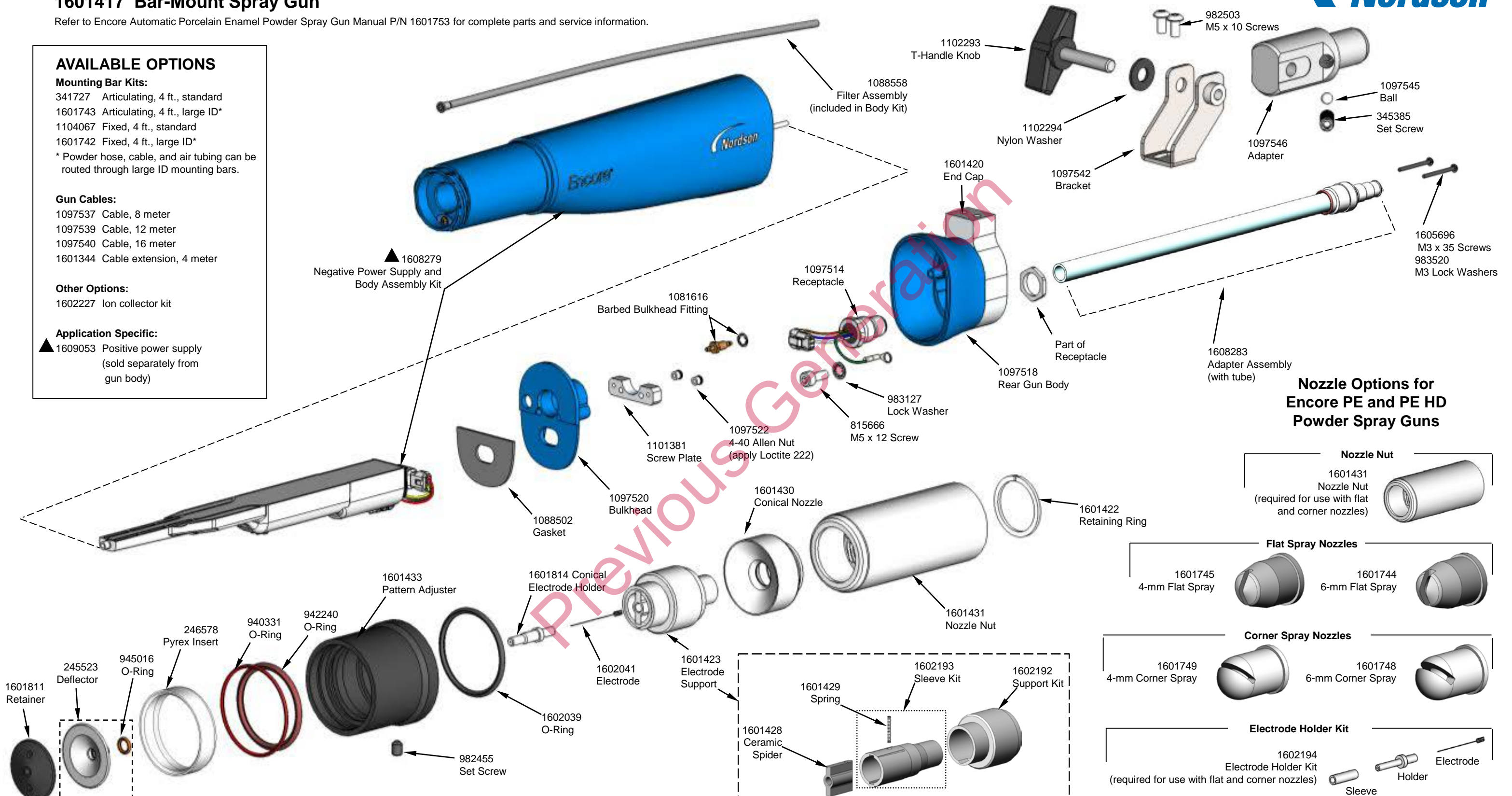

### Nozzle Options for Encore PE and PE HD Powder Spray Guns

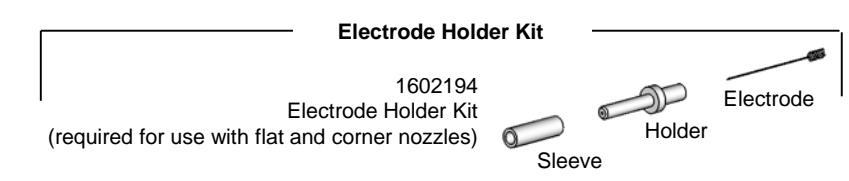
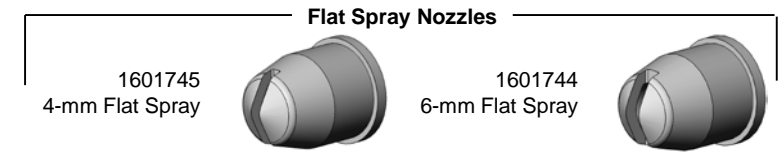
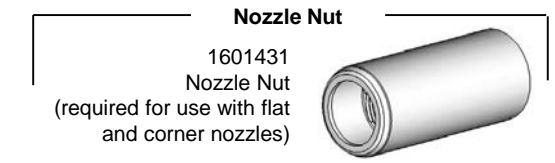

**Nordson Corporation**  
Powder Customer Service

300 Nordson Drive • Amherst, OH 44001 • (800) 433-9319  
Email: finishing\_csc@nordson.com  
www.nordson.com

**Nordson Canada, Limited**

1211 Denison Street • Markham, Ontario L3R 4B3  
(800) 463-3200  
www.nordson.ca

**Nordson Deutschland GmbH**

Heinrich-Hertz-Strasse 42 • 40699 Erkrath, Germany  
Phone: 49-211-9205-0  
Email: powder.systems@de.nordson.com  
www.nordson-finishing-eu.com