

Encore[®] LT Main Control Board Replacement

See Figure 1 for the main control board jumper setting and connections;
Figure 2 for board installation.

Jumper Setting: Set JP1 for the correct type of controller, Automatic or Manual, before installing the board on the keypad.

1. Remove the bezel and keypad from the enclosure, then disconnect the harnesses from the main control board.

NOTE: To remove the solenoid valve wires from the J4 connector, insert a tool in the small hole in the top front of each orange tab and pull the tab up.

2. Remove the main control board from the keypad with a 3-mm hex key.

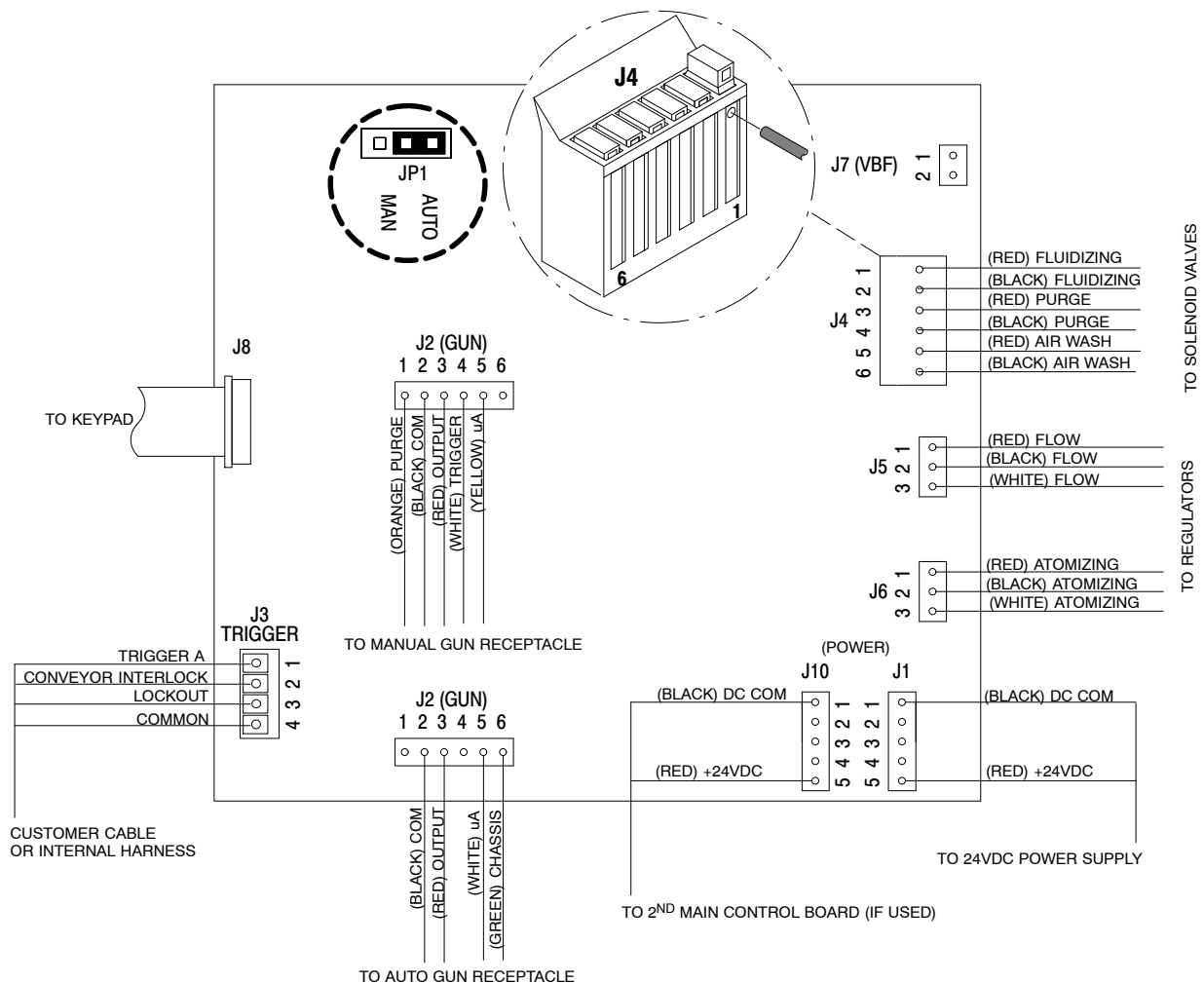

Figure 1 Main Control Board JP1 Jumper Setting and Electrical Connections

3. Install the new main control board on the keypad, then connect the harnesses and cables to the board. Connect the solenoid wires to the J4 connector as follows:
 - a. Insert a tool in the small hole in the top front of each orange tab on the connector and pull the tab up.
 - b. Insert the unstripped solenoid valve wires into the holes in the side of the tabs as shown in Figure 1.
 - c. Press the tabs down. The tabs pierce the wire insulation and clamp the wires in place.
4. Install the keypad and bezel back onto the enclosure.

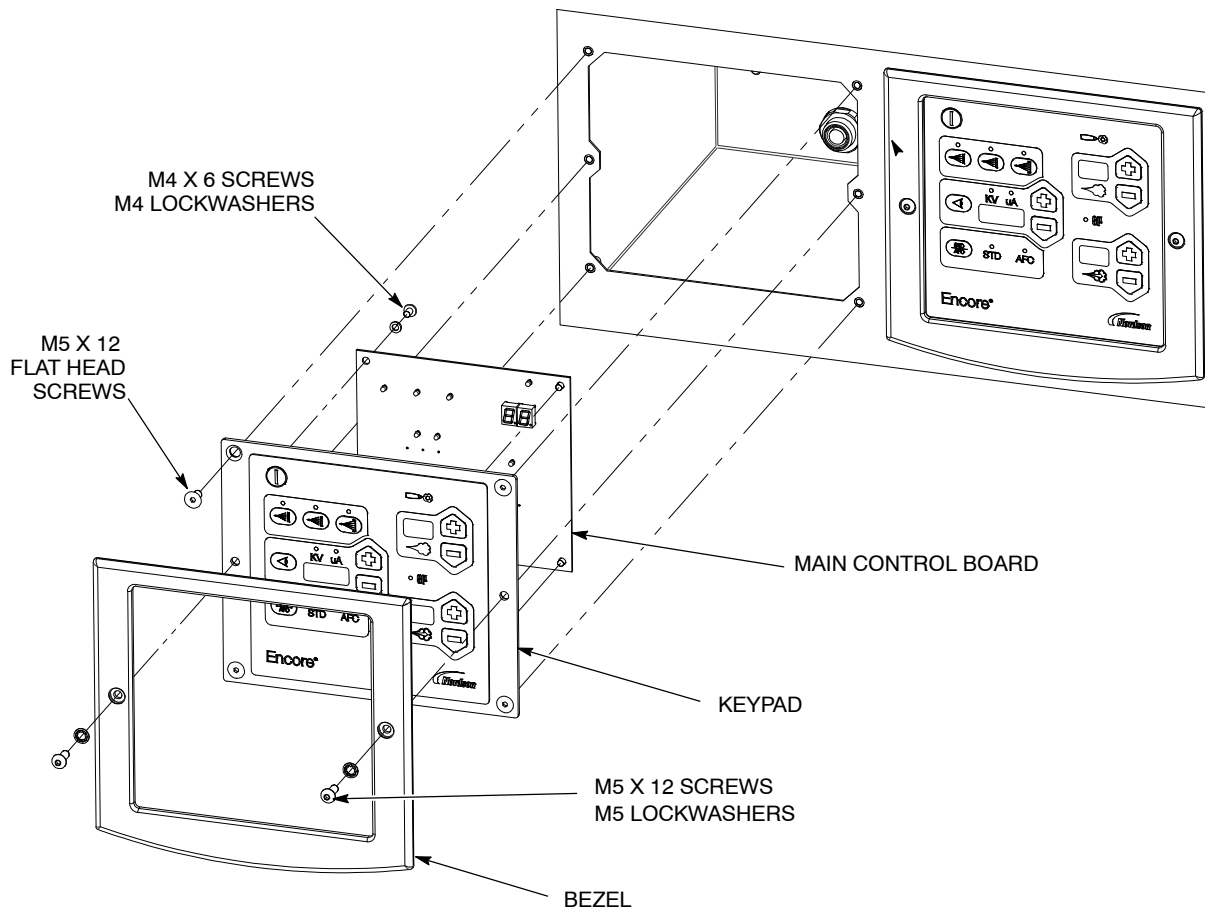

Figure 2 Main Control Board Installation

Issued 6/11

Original copyright date 2011. Encore, Nordson, and the Nordson logo are registered trademarks of Nordson Corporation.