

Prodigy® Hi-Flow HDLV® Pump Fluidizing Tube Retrofit or Replacement



WARNING: Allow only qualified personnel to perform the following tasks. Follow the safety instructions in this document and all other related documentation.



WARNING: Shut off and relieve system air pressure before performing the following tasks. Failure to relieve air pressure may result in personal injury.

Retrofit

1. Relieve the air pressure. Remove the purge air tubing and the push-in elbows from the pump cabinet bulkhead fittings.

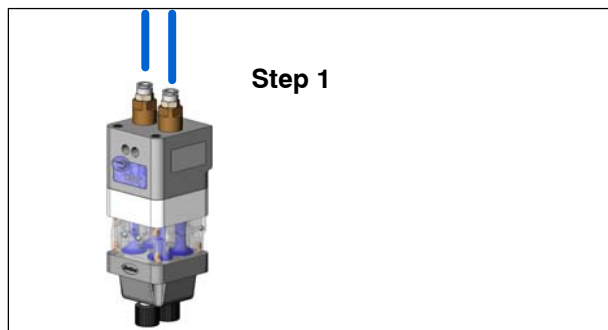

2. Remove the two screws that secure the pump to the cabinet.
3. Unscrew and remove the access plugs and fluidizing tubes from the pump body.

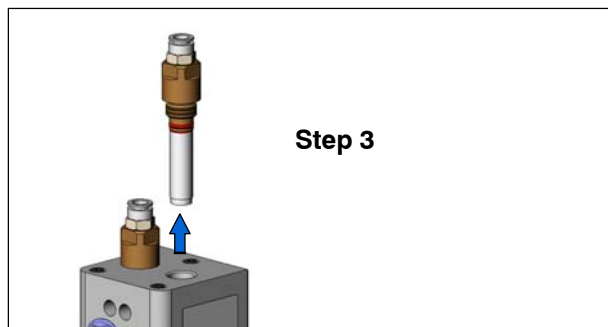

4. Pull the fluidizing tubes off the access plugs, then seat the new fluidizing tubes against the red O-rings.

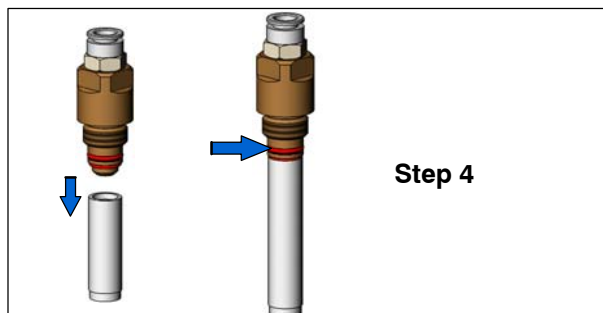

5. Install the O-rings and adapters included in the retrofit kit into the pump body, then install the fluidizing tubes and access plugs into the adapters. Tighten the access plugs.

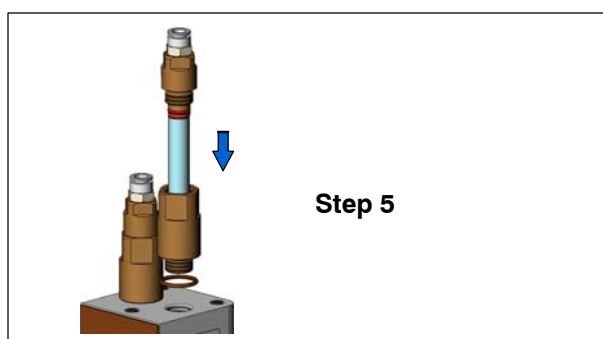

6. With a tubing cutter, cut each piece of tubing to 1.75 in. long.
7. Install the tubing into the access plug fittings, then install the push-in elbows on the tubing.
8. Push the elbow fittings into the pump cabinet bulkhead fittings.
9. Secure the pump to the pump cabinet with the two screws.

2 Prodigy High-Flow HDLV Pump Fluidizing Tube Retrofit or Replacement

Replacement

1. Relieve the air pressure.
2. Remove the two screws securing the pump to the pump cabinet.
3. Pull the push-in elbows out of the cabinet bulkhead fittings.
4. Unscrew and remove the access plugs and fluidizing tubes from the adapters.



5. Pull the fluidizing tubes off the access plugs, then seat the new fluidizing tubes against the red O-rings.

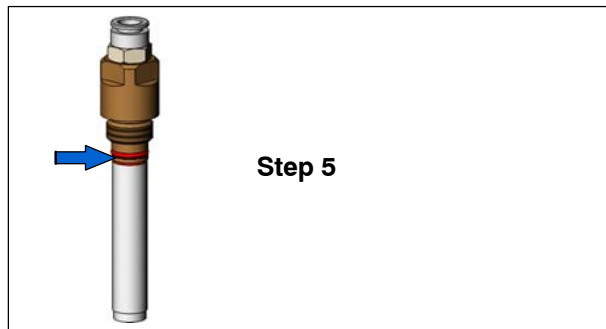

6. Install the fluidizing tubes and access plugs into the adapters. Tighten the access plugs.

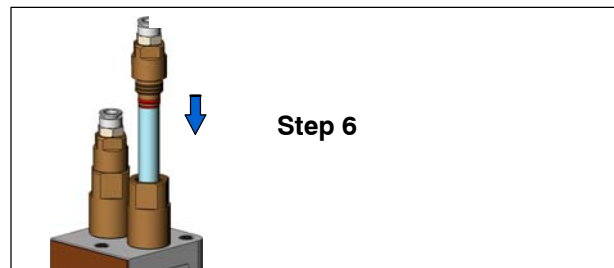

7. Install the tubing into the access plug fittings, then install the push-in elbows on the tubing.
8. Push the elbow fittings into the pump cabinet bulkhead fittings.
9. Secure the pump to the pump cabinet with the two screws.

Parts

Part	Description	Note
1093596	KIT, hi-flow retrofit, HDLV pump	A
1093557	KIT, hi-flow fluid tube, HDLV pump, 4 pack	B
NOTE A: Converts standard HDLV pump to a hi-flow pump.		
B: Contains 4 fluidizing tubes. Order to replace hi-flow fluidizing tubes when they clog or wear out.		

Issued 8/10

Original copyright date 2009. HDLV, Prodigy, Nordson, and the Nordson logo are registered trademarks of Nordson Corporation.