

# Vertical Mount Cartridge Filters

## Installation Guide for Nordson High-Efficiency and PowderGrid® Filters

### Procedure



**WARNING:** Allow only qualified personnel to perform the following tasks. Follow the safety instructions in this document and all other related documentation.

1. Remove and properly dispose of the old cartridge filters. Refer to your powder coating system manual for removal procedures.

**NOTE:** Keep all of the hardware and the centering bracket to install the new cartridge filter.

2. Clean the sealing surface on the underside of the mounting plate.

**NOTE:** Do not install damaged cartridge filters. If the filter was damaged during shipment, contact the freight carrier. Otherwise, contact your Nordson representative.

3. Inspect each new cartridge filter for damage including:

- Nicks or cuts in the rubber gasket
- Tears or holes in the filter media
- Bent or dented end caps
- Dented screens

4. See Figure 1. Install the gasket washer (5) onto the crank (1) then slide the assembly through the hole in the bottom end cap of the cartridge filter.
5. Install the centering bracket (4) onto the threaded end of the crank and snap it into position inside the open end cap of the cartridge filter.
6. Install the square nut (2) onto the threaded portion of the crank and turn approximately five turns.
7. Install the cartridge filter assembly into the color module by inserting the square nut into the notched portion of the retaining bracket on the tube sheet.



**CAUTION:** Do not overtighten the crank element. Filter damage may occur.

8. Turn the crank to lift the cartridge filter until the gasket is compressed to  $\frac{7}{16}$  in.
9. Install the hex nut (3) and lock it into position over the square nut to prevent the filter from loosening.
10. Check the alignment of the cartridge and use a feeler gauge to check the gasket compression.

**NOTE:** Do not use old gasket seal, part number 107810.

## Parts

See Figure 1.

| Item | Part   | Description                                 | Quantity |
|------|--------|---|----------|
| 1    | 183904 | CRANK, element                              | 1        |
| 2    | 183905 | NUT, square                                 | 1        |
| 3    | 984170 | NUT, hex, regular, $\frac{1}{2}$ -13, steel | 1        |
| 4    | 183903 | BRACKET, centering, Torit                   | 1        |
| 5    | 183902 | GASKET WASHER                               | 1        |

NOTE: If your system does not use the vertical mounting method shown in Figure 1, contact your Nordson Corporation representative for a cartridge mounting upgrade. Do not install vertical mount filters with "towers." Towers should be removed and replaced with flange mount filters.

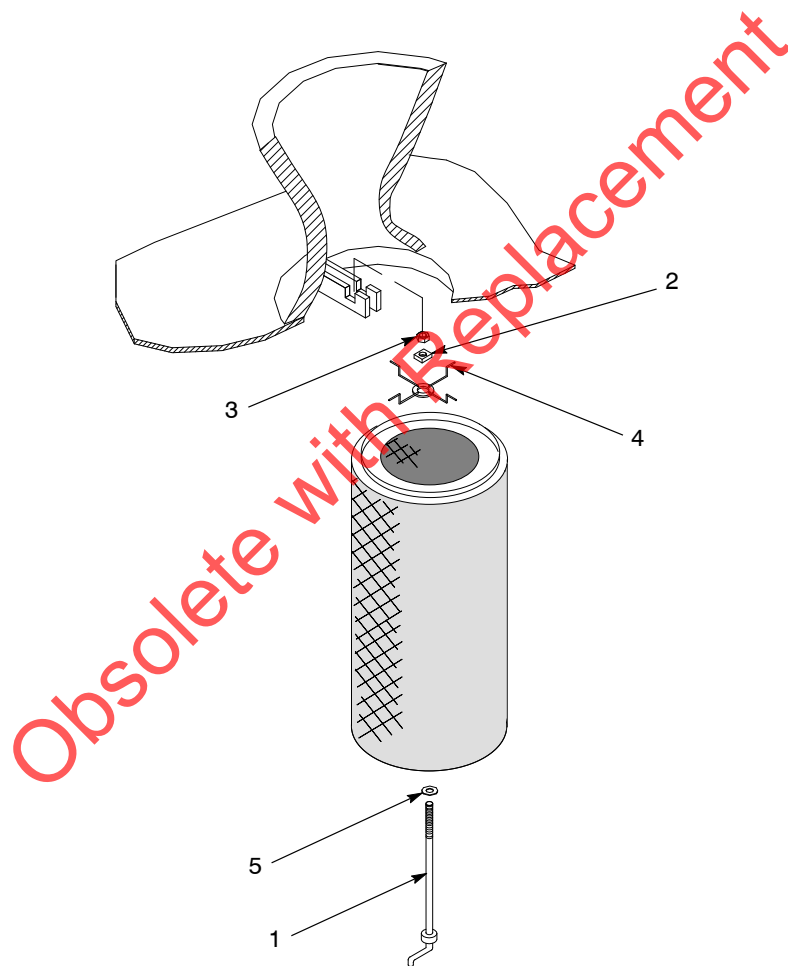

1401130B

Figure 1 Vertical Mount Cartridge Filters

Issued 2/04

Original copyright date 2003. Nordson, the Nordson logo, and PowderGrid are registered trademarks of Nordson Corporation.