

ezSPC Manifold Retrofit Fittings Kit

Description



WARNING: Allow only qualified personnel to perform the following tasks. Follow the safety instructions in this document and all other related documentation.

In applications where the ezSPC manifold will replace a Nordson spray pressure control manifold, a retrofit fittings kit may be required to maintain the current configuration of the fluid system. The retrofit fittings extend the ezSPC manifold height to match the previous spray pressure control manifold's mounting location.

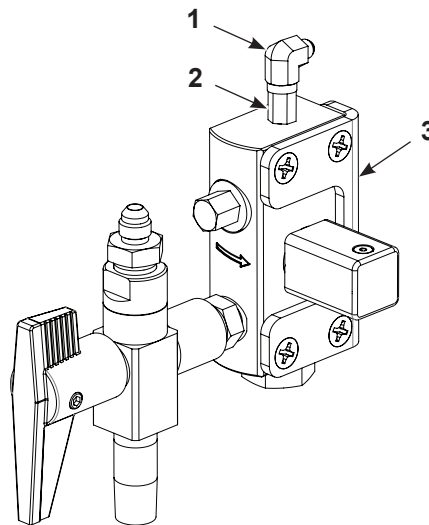

Figure 1 ezSPC manifold with Retrofit Fittings

Installing the Retrofit Fittings



WARNING: Relieve system fluid pressure before performing maintenance on the ezSPC manifold. Failure to observe this warning may cause personal injury or equipment damage.

See Figure 1.

1. Apply a band of PTFE tape to all exposed male threads on the retrofit fittings.
2. Lightly coat all threads with thread sealant as required.
3. Begin threading the extension fitting (2) into the ezSPC manifold body (3). Using a 1/2 inch crescent or adjustable wrench, tighten the extension fitting (2) until snug in the ezSPC manifold body (3).
4. Thread the 90-degree elbow fitting (1) into the extension fitting. Hold the extension fitting with a crescent wrench to prevent overtorquing the fitting into the ezSPC manifold body.

NOTE: Ensure the 90-degree elbow fitting is oriented properly to connect to the fluid system.

Parts

See Figure 2.

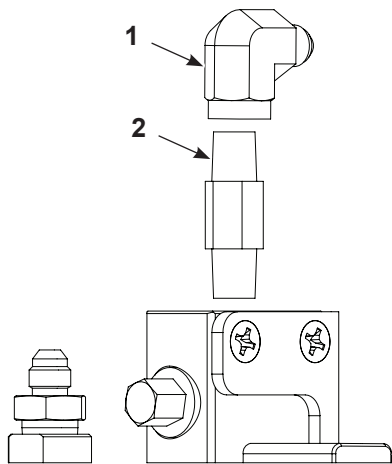

Figure 2 ezSPC Retrofit Fittings Kit

Item	Part	Description	Quantity	Note
—	1620640	SERVICE KIT, retrofit fittings, ezSPC	—	
1	-----	• FITTING, elbow ,1/4 NPTF X 1/2-20 M JIC, stainless	1	
2	-----	• FITTING, pipe ,1/4 NPTF X 1/4 NPTF X 2 in., stainless	1	
NS	900481	ADHESIVE, pipe sealant(PST)	AR	
AR: As Required				
NS: Not Shown				

Issued 02/23

Original copyright date 2021. Nordson and the Nordson logo are registered trademarks of Nordson Corporation.

All other trademarks are the property of their respective owners.