

Driver Module Adjustment

Ink-Dot™ Series I

Adjusting Dot Size



WARNING: Allow only qualified personnel to perform the following tasks. Follow the safety instructions in this document and all other related documentation.



WARNING: Disconnect equipment from line voltage. Failure to observe this warning may result in personnel injury, death, or equipment damage.

1. See Figure 1. Remove the screws (1) and washers (2) securing the driver module (3) to the enclosure (4).

NOTE: The driver module has two channels. Each channel controls one spray gun. The channel potentiometers are located on the back side of the driver module.

2. Turn the desired channel potentiometer (5, 6) using the trimmer adjustment tool provided with this kit.

To Increase Dot Size: Turn the potentiometer clockwise.

To Decrease Dot Size: Turn the potentiometer counterclockwise.

3. Use the screws and washers to install the driver module to the enclosure. Tighten the screws securely.

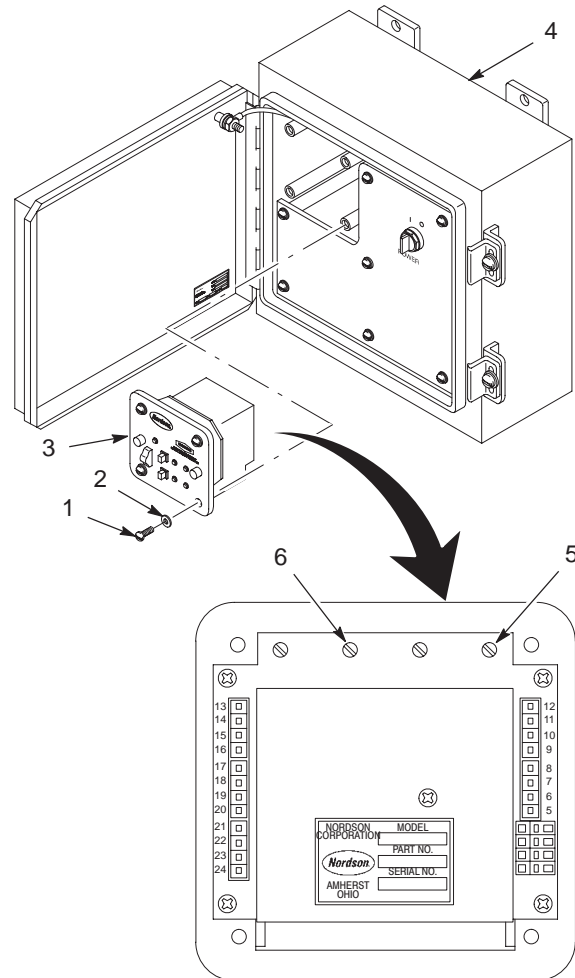

1200147A

Figure 1 Driver Module Adjustment

- | | |
|------------------|----------------------------|
| 1. Screws | 4. Enclosure |
| 2. Washers | 5. Channel 1 potentiometer |
| 3. Driver module | 6. Channel 2 potentiometer |

Driver Adjustment Tool

Item	Part	Description	Quantity	Note
—	179375	KIT, driver adjustment	1	
1	-----	• TOOL, trimmer adjustment	1	

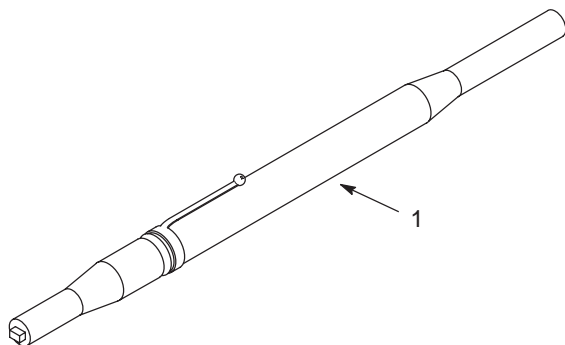

1200148A

Figure 2 Driver Adjustment Kit

Issued 9/03

Original copyright date 1995. Nordson and the Nordson logo are registered trademarks of Nordson Corporation.

Ink-Dot is a trademark of Nordson Corporation.