

CleanSpray® XT System Component Replacement Procedures

T-Filter 15-Micron Filter Element

1. Turn off the spray machine.
2. Close the two-way valve (1) ahead of the miniature T-filter (2).
3. Open the T-filter dump valve (3).
4. Remove the T-filter bypass nut (3), filter element, and metal gasket from the T-filter. Do not lose the metal gasket.

NOTE: Sintered filter elements cannot be cleaned well enough for re-use. They should be replaced with new elements on a regular schedule.

5. Install a new 15-micron filter element in the T-filter. Install the metal gasket.
6. Install the bypass nut on the T-filter.
7. Close the T-filter dump valve (3).
8. Open the two-way valve (1).
9. Open the dump valve (3) and bleed all air out of the system.
10. Close the dump valve.
11. Open the dump valve (6) on the dual-manifold assembly (5) and bleed all air out of the system.
12. Close the dump valve.
13. Trigger the CleanSpray XT spray guns several times with the push button to bleed off any remaining air.
14. Start the spray machine and resume operation.

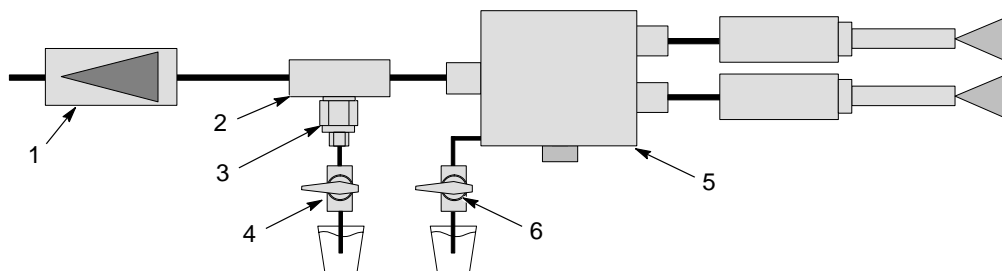

Figure 1 T-Filter Filter Element Replacement

- | | | |
|----------------------------|------------------------|-----------------------------|
| 1. Spray gun two-way valve | 3. T-filter nut | 5. Dual manifold assembly |
| 2. Miniature T-filter | 4. T-filter dump valve | 6. Dual manifold dump valve |

Dual Manifold CO-Plate

1. Turn off the spray machine.
2. Close the two-way valve (1) ahead of the miniature T-filter (2).
3. Open the dual manifold dump valve (3).
4. Remove the plug and CO-plate (4) with the special tool from the dual manifold assembly (5).
5. Clean or replace the CO-plate.
6. Lubricate the CO-plate O-ring.
7. Install the CO plate and plug (4) into the dual manifold assembly.
8. Close the dump valve (3).
9. Open the two-way valve (1).
10. Open the dump valve (3) and bleed all the air out of the system.
11. Close the dump valve.
12. Trigger the CleanSpray XT spray guns several times with the push button to bleed off any remaining air.
13. Start the spray machine and resume operation.

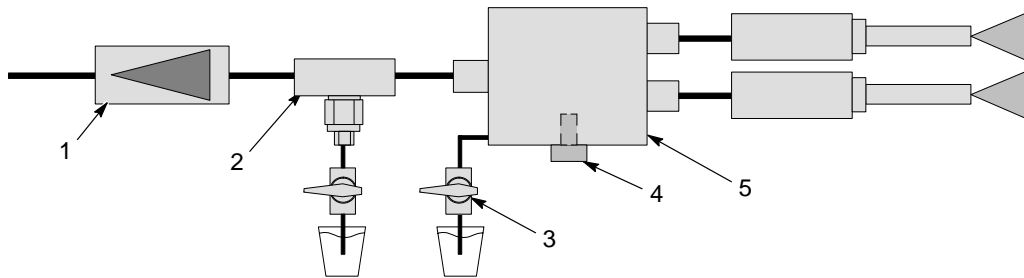

Figure 2 Dual Manifold CO-Plate Replacement

- | | | |
|-------------------|---------------------------------|---------------------------|
| 1. Two-way valves | 3. Dual manifold dump valve | 5. Dual manifold assembly |
| 2. T-filter | 4. C/O plate plug and C/O plate | |

CleanSpray XT Gun Nozzle

1. Turn off the spray machine.
2. Swing out the spray gun mounting bracket.
3. Unscrew the nozzle (1) from the CleanSpray XT gun (2).
4. Install the new nozzle and tighten it securely.
5. Trigger the CleanSpray XT gun several times with the push button to bleed all air out of the system and gun.
6. Position the CleanSpray gun so that the spray from the gun hits the lacquer spray gun nozzle directly on the carbide tip.
7. Swing the spray gun mounting bracket into position.
8. Start the spray machine and resume operation.

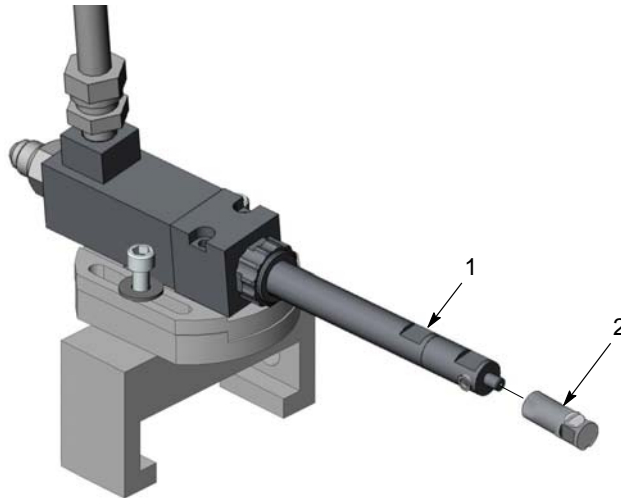

Figure 3 CleanSpray XT Gun Nozzle Replacement

1. Nozzle

2. CleanSpray XT gun

Issued 5/2008

Original copyright date 2007. CleanSpray, Nordson, and the Nordson logo are registered trademarks of Nordson Corporation.