

# Accumulator



**WARNING:** Allow only qualified personnel to perform the following tasks. Follow the safety instructions in this document and all other related documentation.

## Description

See Figure 1. The bladder-type accumulator is a component of the Nordson Corporation Sealant Compound Applicator System. The accumulator provides up to 207 bar (3000 psi) hydraulic pressure to alleviate fluctuations of the spray pattern.

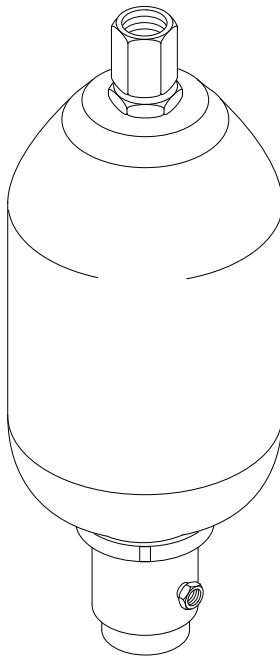

Figure 1 Bladder Type Accumulator

See Figure 2. To attach an accumulator to the sealant compound applicator system, use two accumulator brackets. The system's mounting plate provides mounting holes for the accumulator brackets.

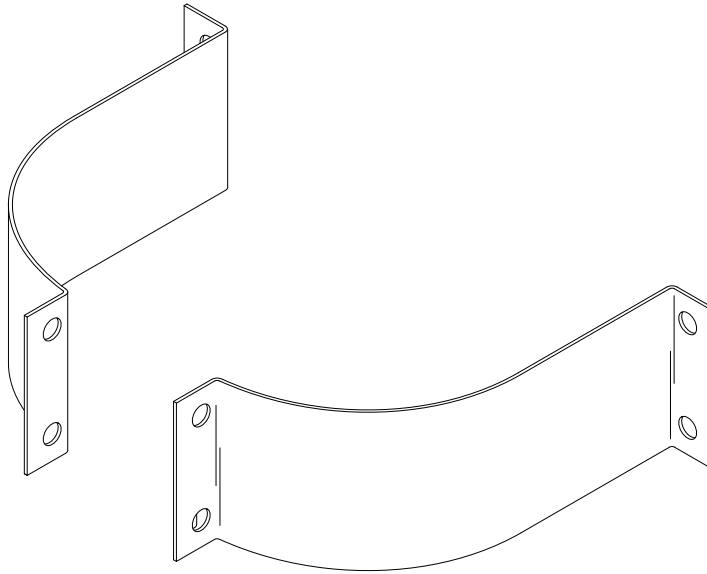

Figure 2 Accumulator Brackets

## Specifications

Height	431.8 mm (17.00 in.)
Diameter	172.2 mm (6.78 in.)
Capacity	3703.5 cm <sup>2</sup> or 3.7 l (226.00 in. <sup>2</sup> or 0.98 gal)
Operating Pressure	207 bar (3000 psi)
Service Temperature	121 °C (250 °F)
Weight	12.7 kg (28 lb)

## Parts

Item	Part	Description	Quantity	Note
1	242586	Accumulator, bladder-type, 1 gallon	1	A
2	242587	Holder, accumulator	1	
3	981353	• Screw, hex, $\frac{5}{16}$ -18 x 1.25 in., cap, zinc	2	
4	983 52	• Washer, lock, $\frac{5}{16}$ in., zinc-plated steel	6	
5	984140	• Nut, hex, reg, $\frac{5}{16}$ -18 in., zinc-plated steel	2	
6	981342	• Screw, truss, $\frac{5}{16}$ -18 x 0.75 in., zinc-plated steel	4	
NOTE A: Two holders are required to mount the accumulator.				

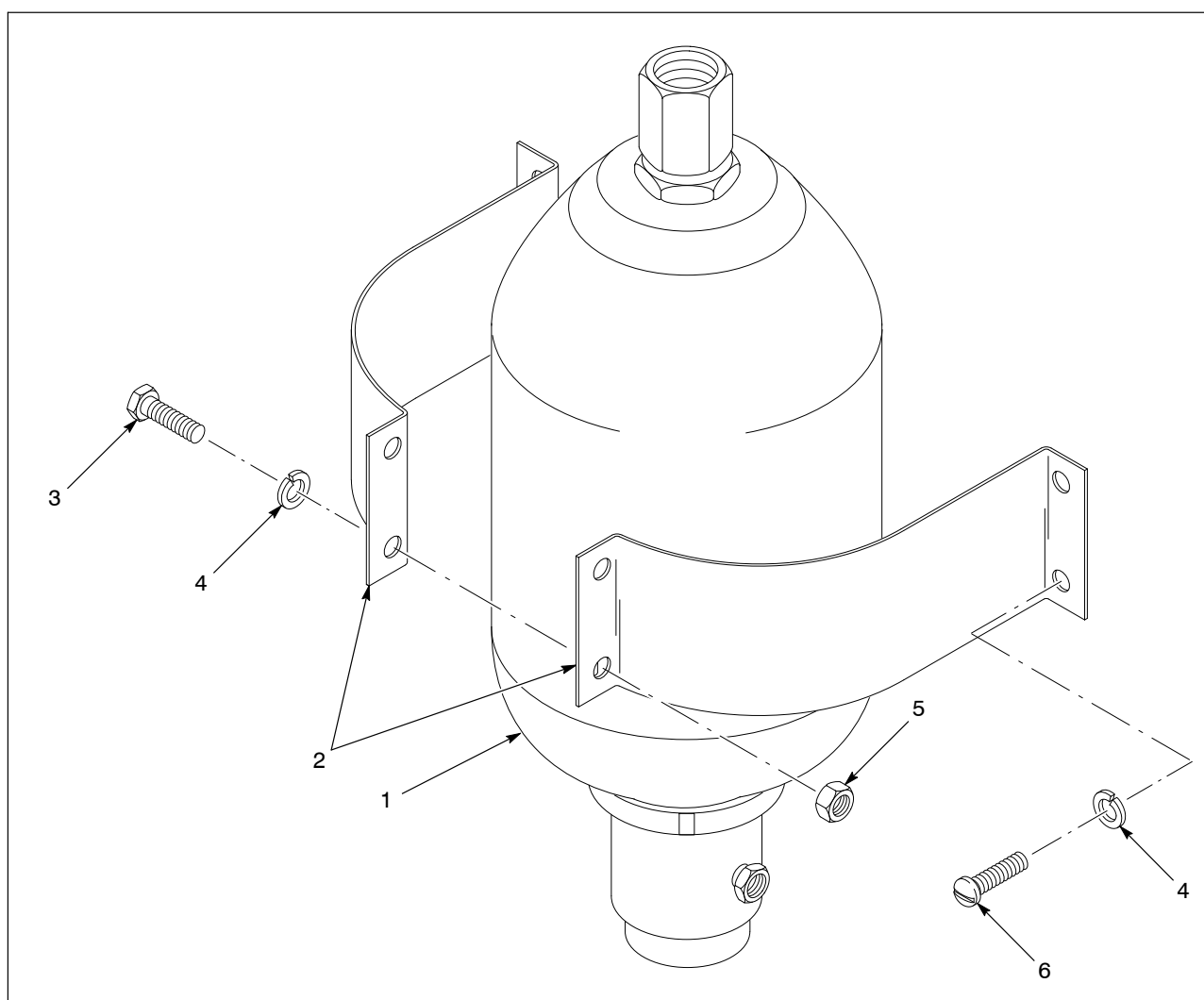

Figure 3 Accumulator and Bracket Parts

Issued 10/99

Original copyright date 1973. Nordson and the Nordson logo are registered trademarks of Nordson Corporation.