



Nordson Corporation

OPERATOR'S CARD

P/N 334459B

GMT Rhino® Unloader Container Change



WARNING

- Allow only qualified personnel to perform the following tasks. Follow the safety instructions in this document and all other related documentation.
- Wear protective clothing, gloves, and safety goggles. Failure to observe may result in serious injury.

NOTE

Unloaders shown in this document may be configured differently, and may not exactly match your specific system setup.

Remove the Old Container

1. See Figure 1. Ensure that the main air valve (11) is turned ON.
2. Turn the rotary valve (9) to the NEUTRAL position.

3. Turn off the air motor lock out valve (12).
4. Open the blow off ball valve (1).
5. Turn the rotary valve (9) to the UP position to initiate the elevator UP movement.
6. Press the clean-out button (8) until the follower plate begins to move.

NOTE

If the container begins to rise off the frame, press the clean-out button to allow the container to return to the frame.

7. Release the clean-out (8) button to continue elevator upward movement.
8. Leave the rotary valve (9) in the UP position until the follower plate (5) is at the top of the container.
9. Close the blow off ball valve (1). The elevator will continue to rise to its maximum height.

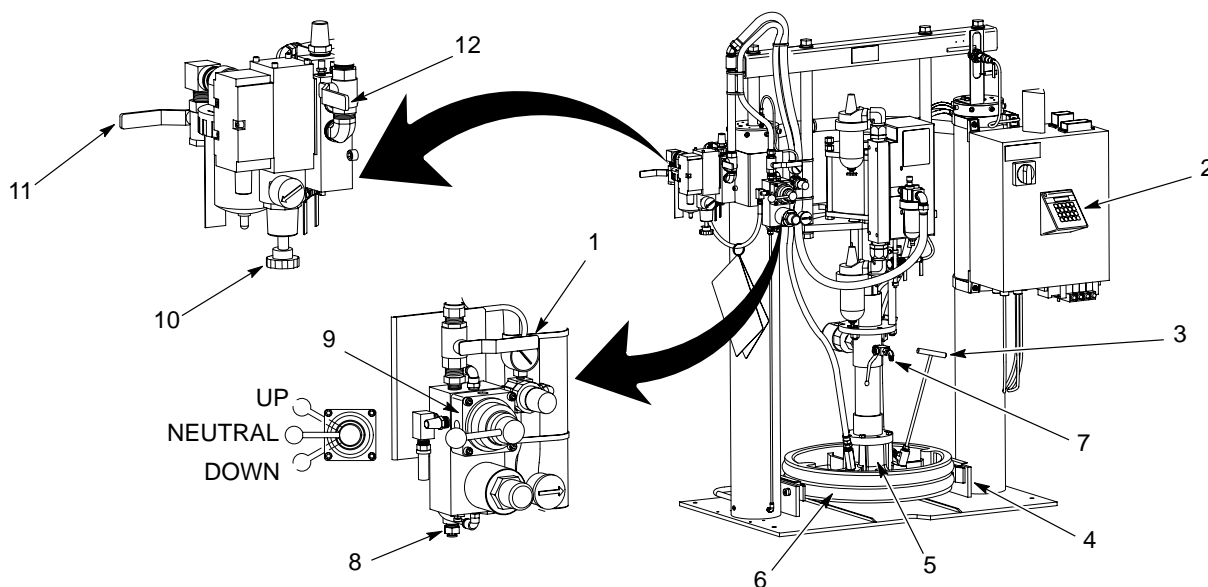

Figure 1

Install the New Container

! CAUTION !

Do not use a damaged container. A damaged container can damage the follower plate, seals or the sealing device when the follower plate is lowered.

1. See Figure 1. Center the new container under the follower plate (5) to properly engage the hold-down (4).
2. Coat the follower plate seals (6) with a compatible lubricant.
3. Remove the bleeder stem (3).



Severe personal injury could result if your hands or fingers are caught between the follower plate and the container. Keep hands clear of this area.

4. Turn the rotary valve (9) to the DOWN position to initiate the elevator DOWN movement. The follower plate starts moving down into the new container.
5. Allow air to bleed from the bleeder stem fitting as the follower plate (5) moves down.
6. When material flows continuously from the bleeder stem fitting, turn the rotary valve (9) to the NEUTRAL position. The elevator DOWN movement stops.
7. Install the bleeder stem (3).
8. Turn the rotary valve (9) to the DOWN position to initiate the elevator DOWN movement, and to apply downward force to the elevator.

Purge Routine

See Figure 1. Use the keypad (2) to perform the following purge routine. The keypad is located on the control cabinet of the A unit. This procedure eliminates the remaining air volume from underneath the follower plate.

1. Adjust the air motor regulator (10) to 0 psi/bar.
2. Press **Menu** on the keypad (2).
The following menu appears:
 1. Purge
 2. Change
 3. Setup
 4. Manual
3. Press **[1]** on the keypad (2).
The following menu appears:
 1. Purge Pump "A"
 2. Purge Pump "B"
4. Select the appropriate pump that needs to be purged.
5. Press **[F1]** on the keypad (2) to start purging the pump.
6. Open the bleed valve (7). Bleed the remaining air through the bleed valve and the dispensers.

NOTE

Make sure that you use minimal pressure at the air motor regulator (10).

7. Press **[F2]** on the keypad (2) to stop the pump.
8. Press **Menu** on the keypad (2) to exit the purge routine.
9. Adjust the air motor regulator (10) to the original operating pressure.

Issued 7/03

Original copyright date 1999. Nordson, the Nordson logo, and Rhino, are registered trademarks of Nordson Corporation.