

Rhino[®] SD2/XD2 5-Gallon Container In-Position Sensor

Description

See Figure 1. The Rhino[®] SD2/XD2 container in-position sensor provides a signal to the system controller to verify a container is in position below the follower plate or heated platen. When a container is placed between the frame material container guides, it makes contact with the sensor plunger and closes the circuit to the system controller. If the sensor plunger does not detect a container, ram movement needs to be manually controlled using the two-hand control buttons.

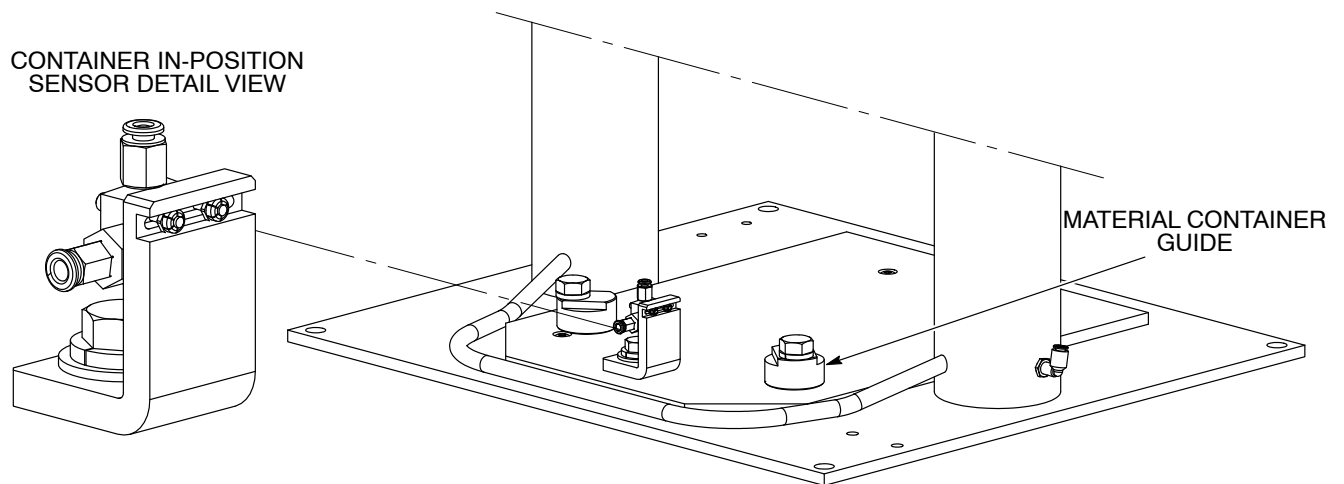

1097218

Figure 1 5-Gallon Container In-Position Sensor

Installation



CAUTION: If the follower plate or heated platen needs to be lowered and a container is not positioned on the frame, place support blocks on the frame base to prevent damage to the container in-position sensor.

See Figure 2.

1. Remove the frame material container guides from the base plate.
2. Install the adapter plate (1) to the base plate with the button head screws (2).
3. Use the socket screws (9) and hex nuts (4) to fasten the sensor (8) to the bracket (3).
4. Use the cap screw (5), lock washer (6), and flat washer (7) to fasten the bracket (3) to the adapter plate (1).
5. Adjust the sensor (8) and material container guides so the sensor plunger is pushed in when a container is placed under the follower.

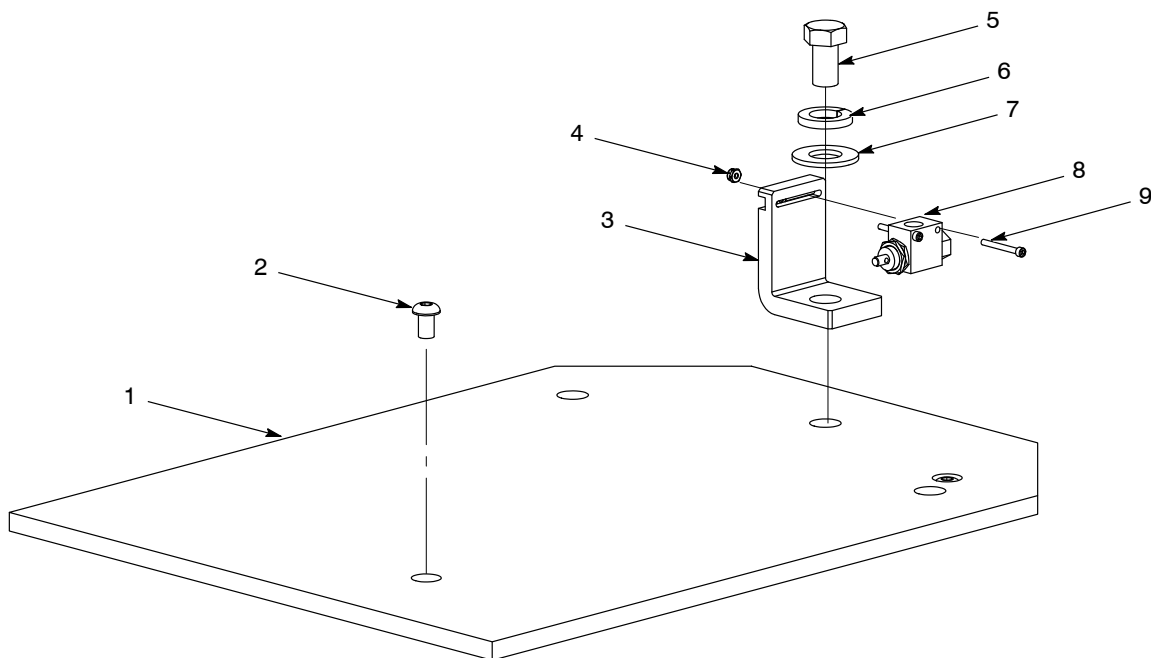

10016672

Figure 2 Container In-Position Sensor Installation

- | | | |
|----------------------|----------------|-----------------|
| 1. Adapter plate | 4. Hex nut | 7. Flat washer |
| 2. Button head screw | 5. Cap screw | 8. Sensor |
| 3. Bracket | 6. Lock washer | 9. Socket screw |

Parts

To order parts, call the Nordson Industrial Coating Systems Customer Support Center at (800) 433-9319 or contact your local Nordson representative.

See Figure 3 and refer to the following parts list.

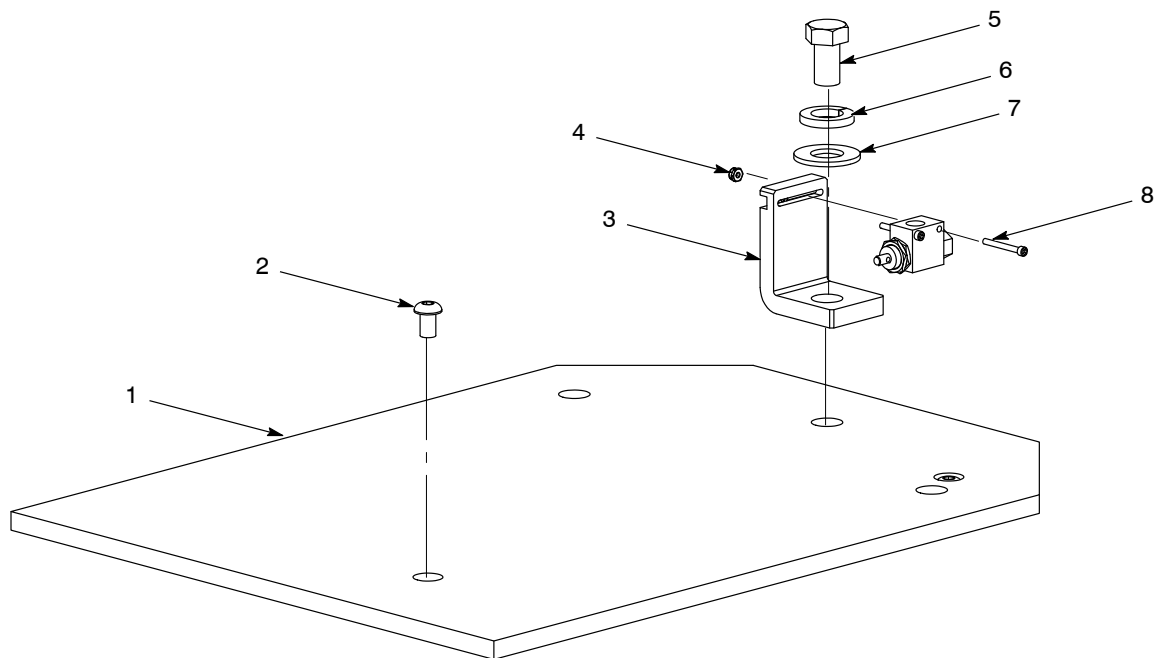

10016672

Figure 3 Container In-Position Sensor Adapter Kit

Item	Part	Description	Quantity	Note
—	1611814	KIT, adapter, 310-mm container, 5-gal unloader	1	
1	-----	• PLATE, adapter, 310 mm container, 5-gal unloader	1	
2	-----	• SCREW, button head, 5/16 – 18 x 0.500, Grade 5, per ISO 7380	2	
3	-----	• BRACKET, 5-gal, container in-position	1	
4	-----	• HEX NUT, lock, 4–40, per ISO 4034	2	
5	-----	• CAP SCREW, hex, 5/8 – “ x 1.0, steel, zinc, per ISO 4762	1	
6	-----	• WASHER, lock, 5/8, steel, per ISO 7089	1	
7	-----	• WASHER, flat, 0.656 x 1.312 x 0.095, zinc, per ISO 7089	1	
8	-----	• SCREW, socket, 4–40 x 1.0, black, Grade 8, per ISO 4762	2	

This page intentionally left blank.

Issued 8/18

Original copyright date 2018. Rhino, Nordson, and the Nordson logo are registered trademarks of Nordson Corporation.

All other trademarks are the property of their respective owners.