

Rhino[®] 55-Gallon 125/160-mm Frame Drum Cart Adapter Plate Kit

Installation



WARNING: Allow only qualified personnel to perform the following tasks. Follow the safety instructions in this document and all other related documentation.

NOTE: Personnel performing this procedure must know how to safely operate the Rhino bulk unloader.

The following items are required to install this kit onto a Rhino 55-gallon 125/160-mm frame:

- 700-lb (318-kg) capacity lifting device
- Torque wrench that measures up to 60 ft-lb (125 N•m)

Block the Follower Plate

See Figure 1.

1. Use blocks (2) to elevate the follower plate (1) high enough to keep it from contacting the drum guides (3).
2. Make sure that the follower plate/air motor assembly is secure to prevent it from tipping.

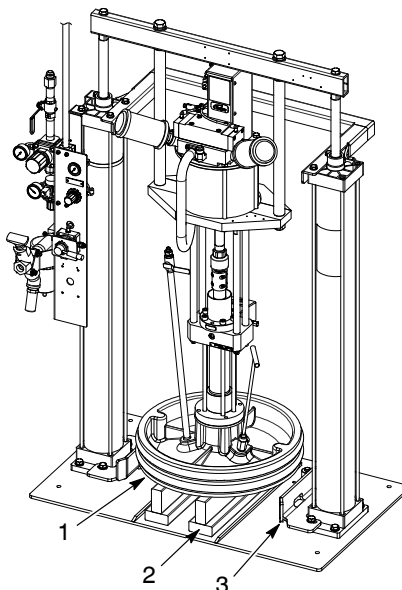

Figure 1 Blocking the Follower Plate

Replace the Drum Guides

See Figure 2.

1. Remove the screws (1), lock washers (2), and washers (3) securing the old drum guides (4) to the air cylinders (5). Do not discard the attaching hardware.
2. Install the new drum guides (4) onto the air cylinders (5) using the screws (1), lock washers (2), and washers (3). Tighten the screws to 60 ft-lb (82 N•m).

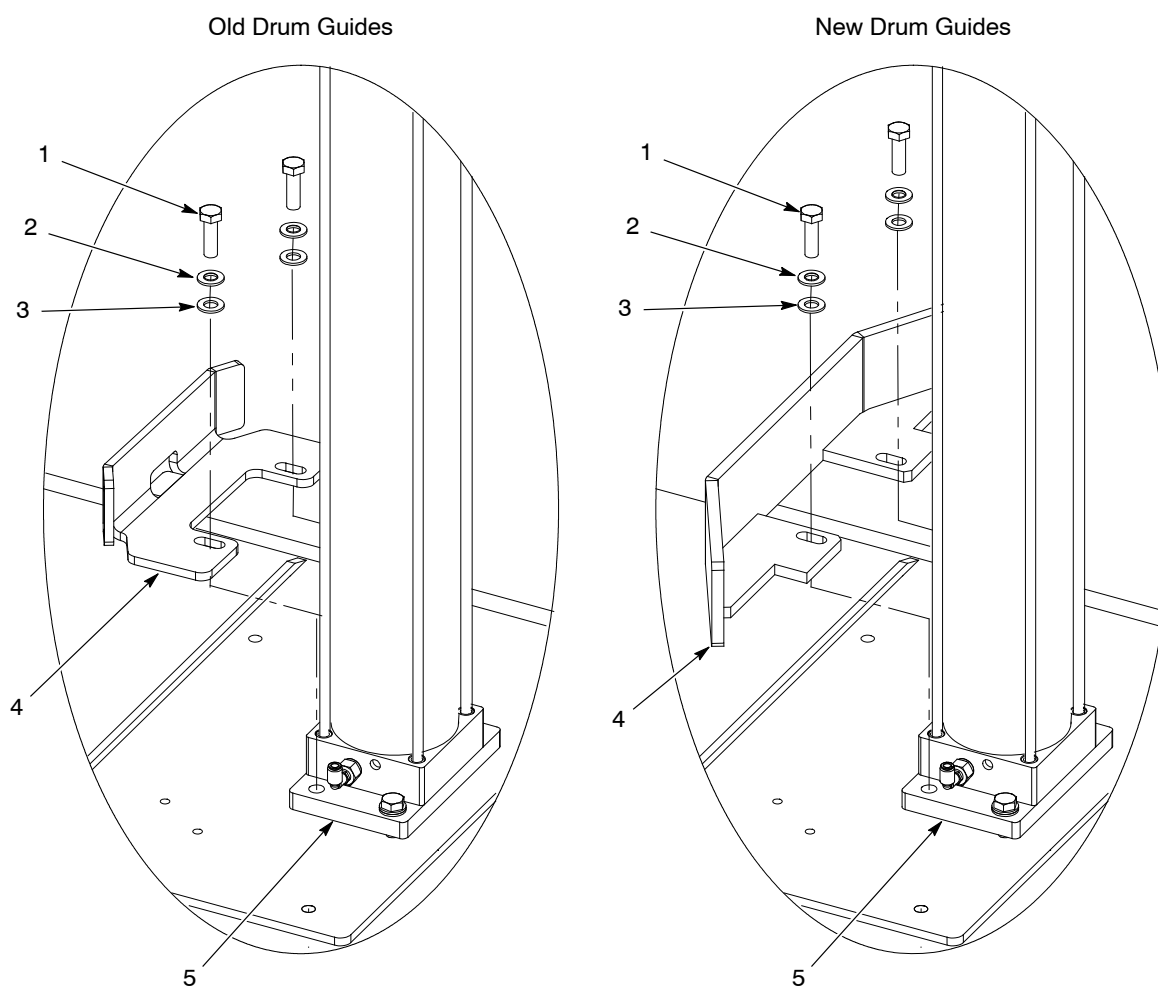

Figure 2 Installing the New Drum Guides

Install the Adapter Plate

NOTE: A 700-lb (318-kg) capacity lifting device is required for this procedure.

See Figure 3.

1. Remove the attaching hardware (1) securing the base (2) to the floor.



WARNING: To prevent personal injury, keep hands and feet away from the bottom of the base when the frame is raised off of the floor.

2. Perform the following:
 - a. Attach a lifting device to the frame as shown.
 - b. Raise the frame high enough to install each adapter plate (3) under the base (2).
 - c. Make sure that the adapter plates (3) are aligned to the base mounting holes. Lower the lifting device.
 - d. Secure the base (2) to the floor using the attaching hardware (1). Tighten the screws securely.
 - e. Remove the lifting device from the frame.

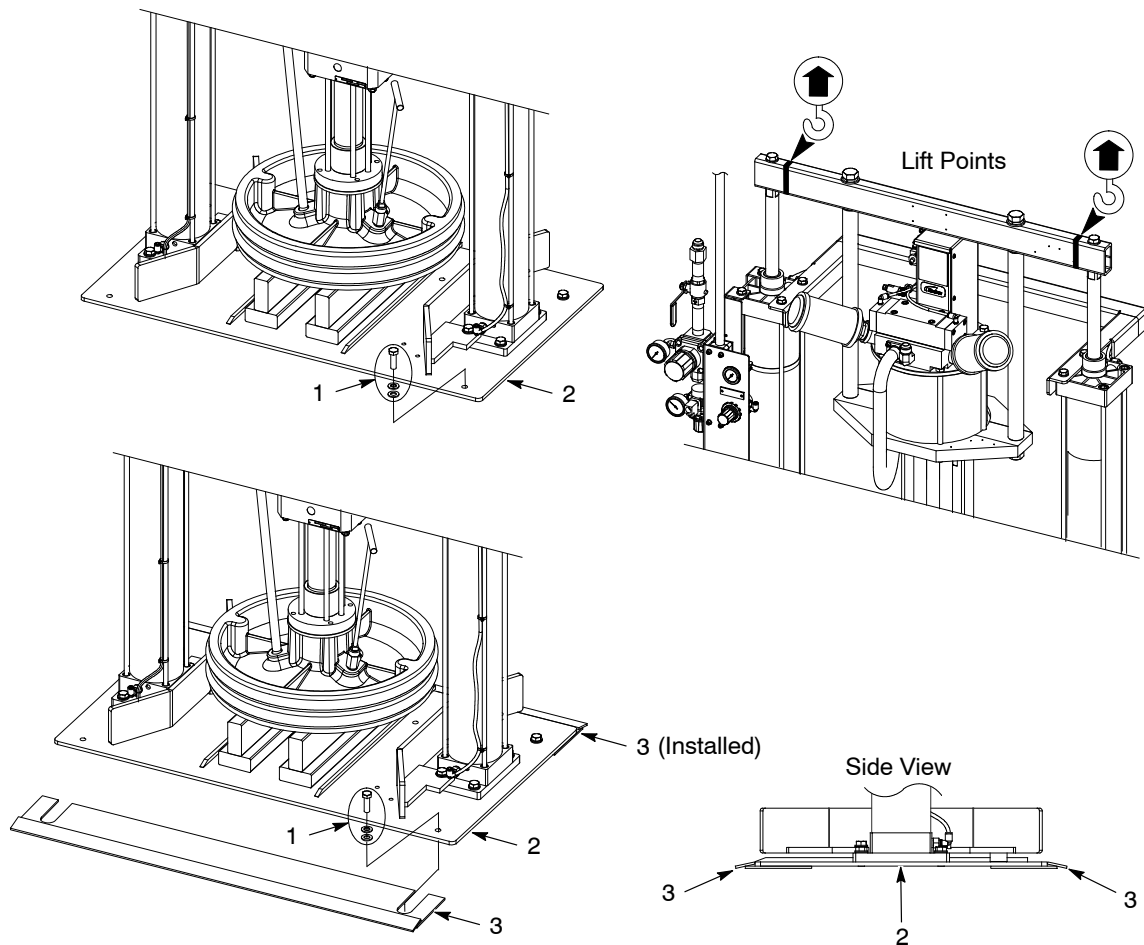

Figure 3 Installing the Adapter Plates

Parts

See Figure 4 and the following parts list.

Item	Part	Description	Quantity	Note
—	1609345	KIT, frame adapter plate, drum cart	1	
1	1609146	• PLATE, guide, 55, 125 mm frame, drum cart	2	
2	1609142	• PLATE, adapter, drum cart	2	

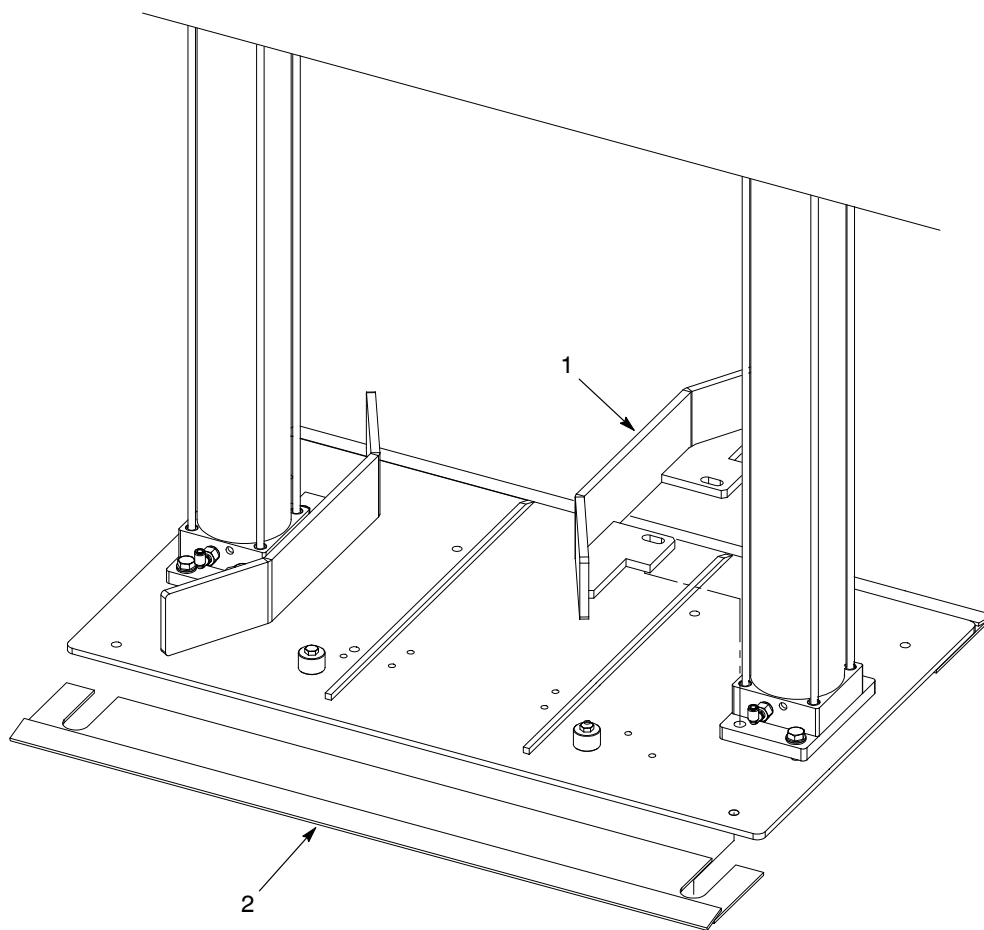

Figure 4 Drum Cart Frame Adapter Plate Parts

Issued 07/2018

Original copyright date 2018. Nordson, the Nordson logo, and Rhino are registered trademarks of Nordson Corporation.