

Description

See Figure 1. When using a 5-gallon follower (5) on a 55-gallon large G-port frame, a pop-off valve (1) must be installed to limit the amount of air pressure that can be applied to the ram cylinders (4) in the downward direction.

The pop-off valve uses spring force to counteract the air pressure force. When the force created from the air pressure becomes greater than the spring force, the valve pops fully open and vents air to the atmosphere.

Installation

NOTE: Mount the valve in a vertical position. Horizontal mounting may affect operation of the valve.

1. Remove the plug (2) from the port marked G on the air cylinder (3).
2. Apply adhesive to the threads of the pop-off valve (1). Install the pop-off valve to the air cylinder and tighten securely.

Parts

To order parts, call the Nordson Customer Service Center or a local Nordson representative.

Part	Description
1082579	Pop-off valve, 20 psi, G-Port

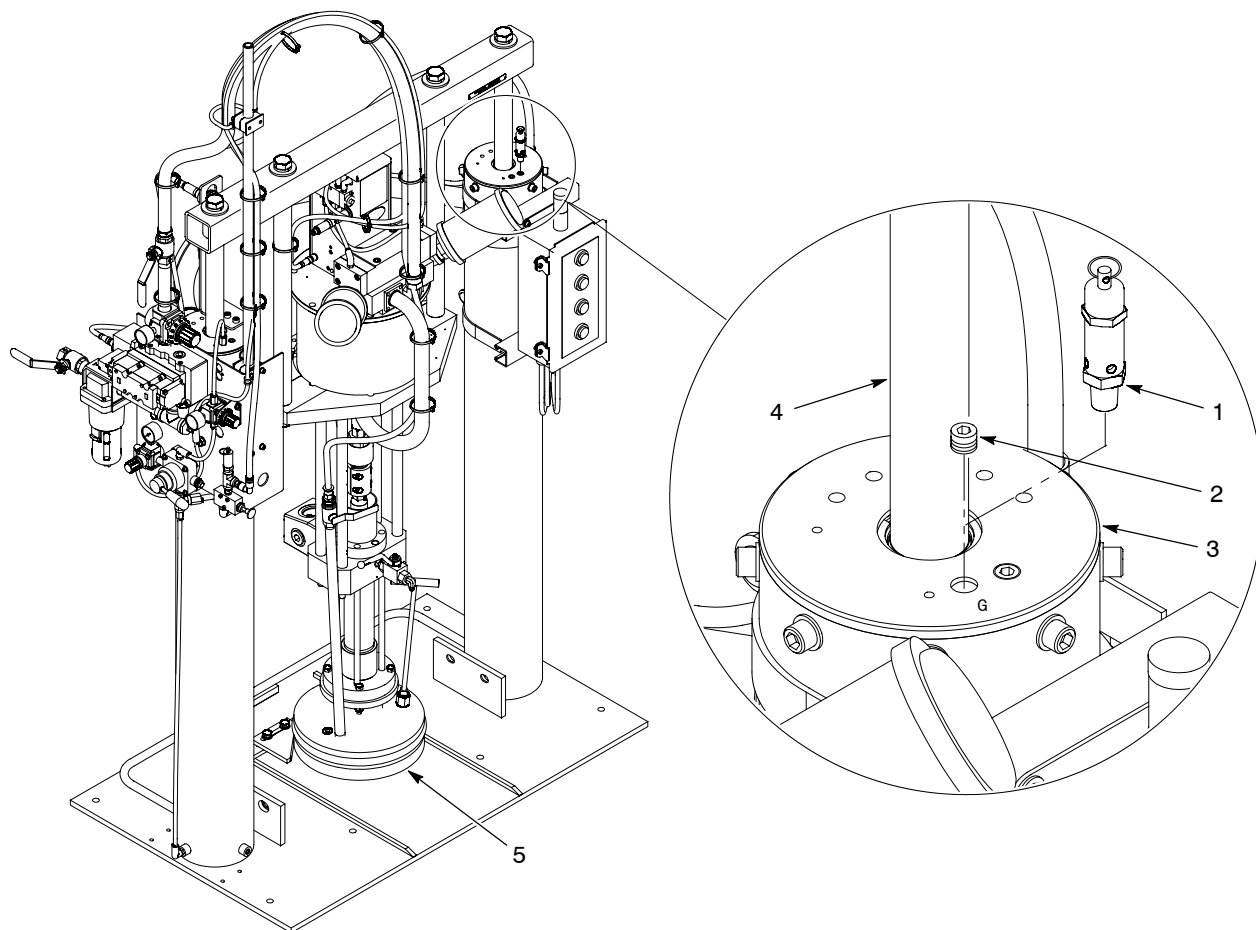

Figure 1 Typical Installation

Change Record

[illegible]

Issued 6/09

Original copyright date 2009. Nordson, the Nordson logo, and Rhino are registered trademarks of Nordson Corporation.
All other trademarks are the property of their respective owners.