



WARNING: Allow only qualified personnel to perform the following tasks. Follow the safety instructions in this document and all other related documentation.

NOTE:

This procedure requires the use of the following items:

- Hydraulic or arbor press, a removal fixture, and a removal arbor to remove the packing gland parts
- Insertion tool to install the new packing gland parts

1. See Figure 1. Remove the retaining ring (10).
2. Place the packing gland housing (2) on a fixture (5) with the solvent cup end facing up.

3. Insert the removal arbor (1) into the packing gland housing. Using the press, push out the internal parts (3).
4. Thoroughly clean the packing gland housing in a compatible solvent to remove all sealant material and O-ring debris.
5. Coat the bore (8) of the packing gland housing with O-ring lubricant (9).
6. Insert the scraper (7), sharp edge down, into the the packing gland (2).
7. Using the insertion tool (6) and press, insert the new internal parts into the packing gland housing (2).
8. Install the new retaining ring (10).

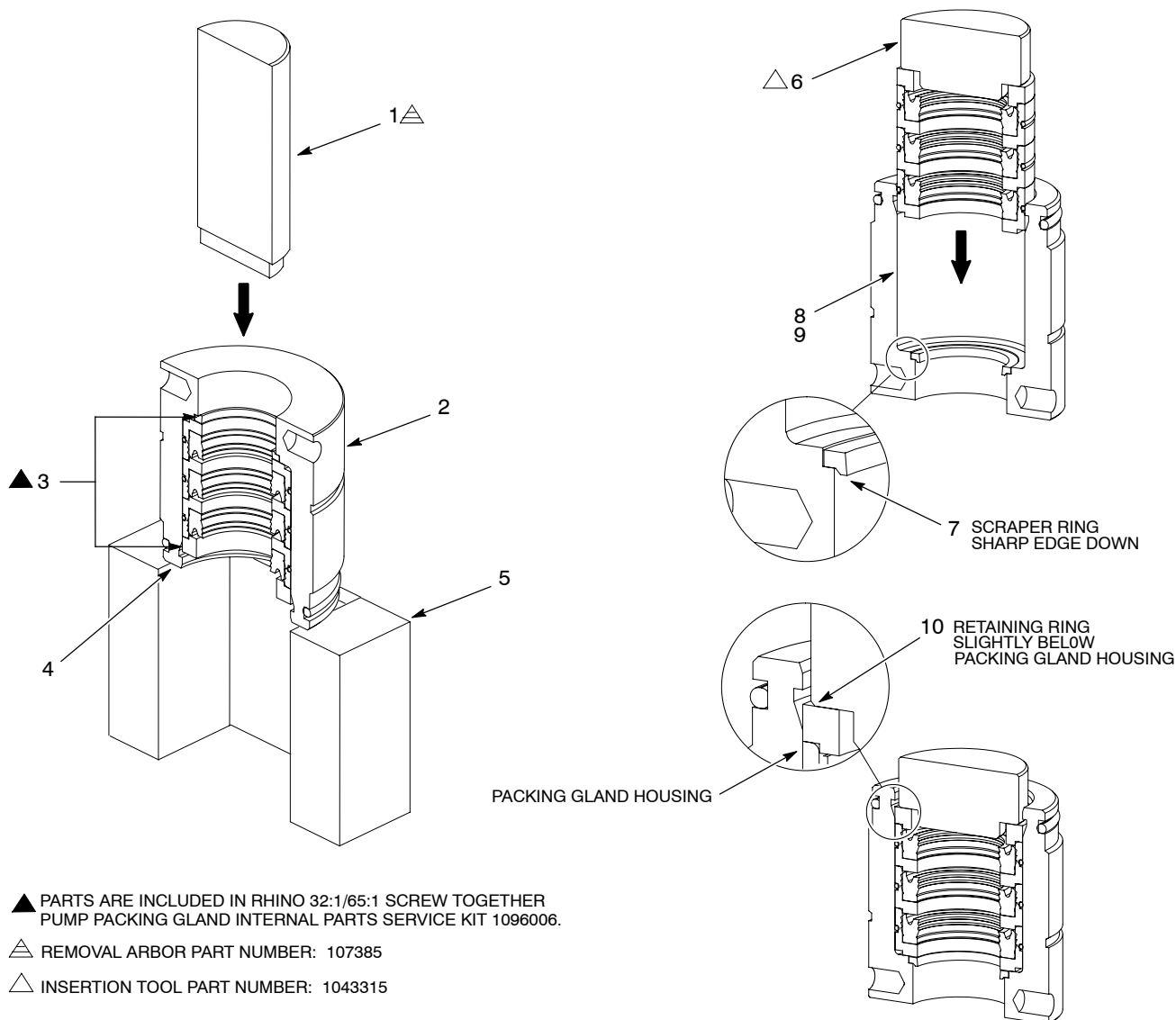

Figure 1 Internal Packing Gland Parts Replacement