

Description

See Figure 1 and refer to Table 1. The J-Box module provides the interface between the Rhino XD2H Four-Post bulk unloader electrical components and the system controller. The J-Box module mounts to Rhino XD2H Four-Post control module.

The J-Box module is designed for two-hand operation. The operator controls (1) enable ram movement. Both 2-HAND CONTROL push buttons must be pressed at the same time to enable the bulk unloader ram movement. Refer to the *Using the Ram Controls* section for a functional description of the operator controls.

The cables (2) provide the electrical interface between the J-Box, limit switches, proximity sensors, control valves, and heated platen.

NOTE: The electrical interface between the J-box and the heated pump platen is routed through a harness assembly. Refer to the *Rhino XD2H Platen/J-Box Harness Assembly* instruction sheet for more information about the harness assembly.

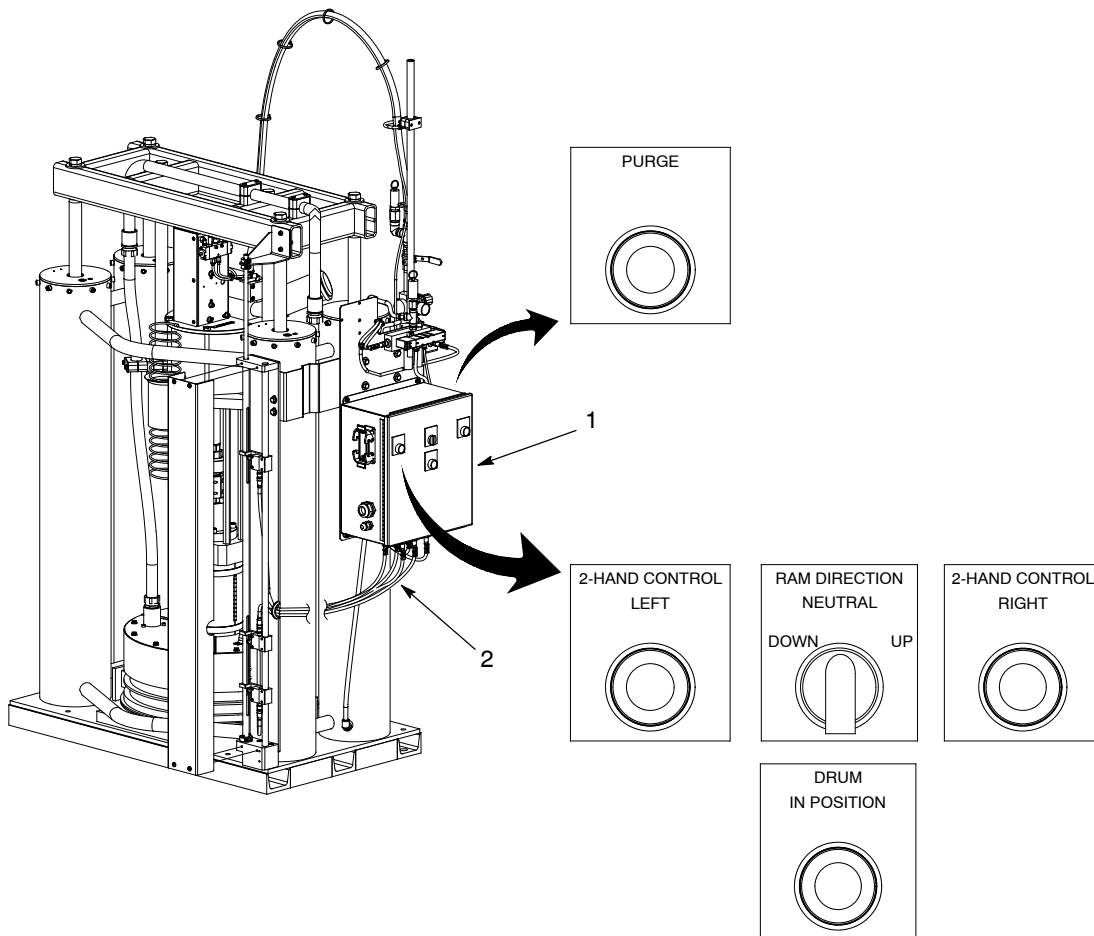

Figure 1 J-Box Module Components

Table 1 Operator Controls

Item	Description
PURGE	Momentary push button for purging material from the inactive pump during drum changes
2-HAND CONTROL LEFT/RIGHT	Enables/disables ram movement
RAM DIRECTION	Ram movement
DRUM IN POSITION	Illuminates when a drum is positioned under the follower plate.

Installation



WARNING: Allow only qualified personnel to perform the following tasks. Follow the safety instructions in this document and all other related documentation.

NOTE: Read and understand the *Safety* section in the Nordson *System Documentation* that shipped with the system before installing the Control Module.

1. See Figure 2. Remove the screws (5) and washers (4) securing the drum level detect cover (6) to the bulk unloader (7).

2. Install the J-Box module (1) to the bulk unloader (7) using the washers (2) and nuts (3). Tighten the nuts securely.
3. Connect the cables from the J-Box module (1) to the components on the bulk unloader (7) as shown.
4. Install the drum level detect cover (6) onto the bulk unloader (7) using the washers (4) and screws (6). Tighten the screws securely.

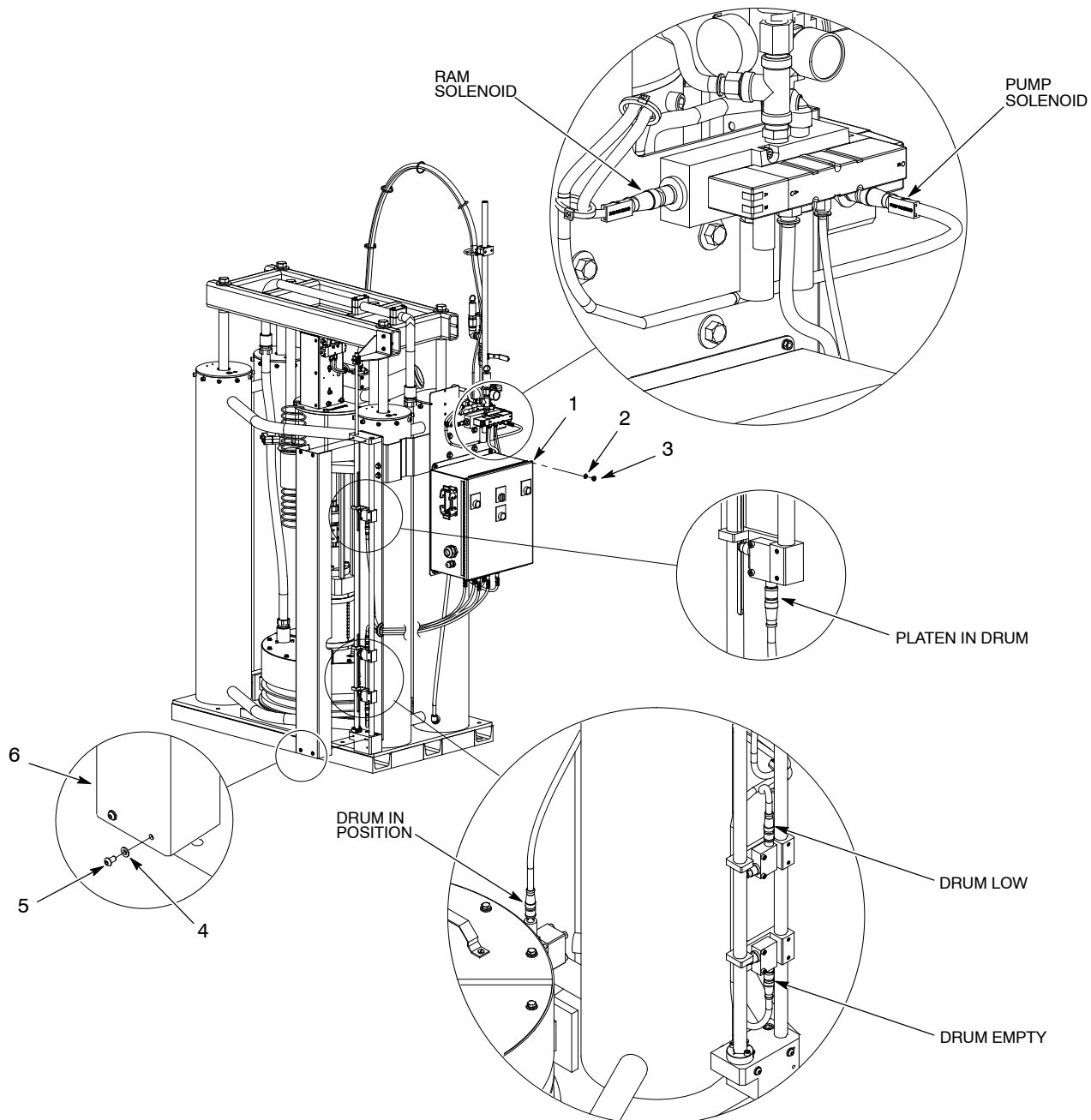

Figure 2 Installation

Operation



WARNING: Allow only qualified personnel to perform the following tasks. Follow the safety instructions in this document and all other related documentation.

NOTE: Read and understand these procedures before operating this equipment. Contact a local Nordson representative regarding these procedures if necessary.

Using the Ram Controls

See Figure 3.

NOTE: It is important to remember that selecting NEUTRAL on the RAM DIRECTION switch stops all ram movement and disables the 2-HAND CONTROL push buttons.

RAM DIRECTION: DOWN/UP

Press and hold in the LEFT/RIGHT 2-HAND CONTROL pushbuttons at the same time to manually lower/raise the rams.

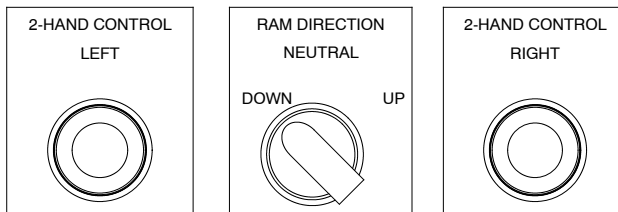

When the follower enables the Follower In Drum switch (A), release the LEFT/RIGHT 2-HAND CONTROL pushbuttons. The rams will automatically move until the follower enables the Drum-Empty switch.

If the bulk unloader does not have a drum positioned under the follower, the Drum In Position switch (C) is disabled. Press and hold in the LEFT/RIGHT 2-HAND CONTROL pushbuttons at the same time to manually lower/raise the rams.

NOTE: The NEUTRAL position on the RAM DIRECTION switch moves the pneumatic ram control valve to the center position and pneumatically locks the rams.

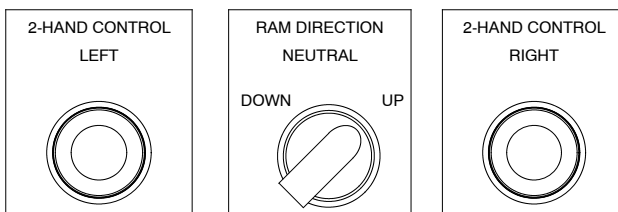

RAM DIRECTION: UP

When the follower enables the the Drum Empty switch (B), press and release the LEFT/RIGHT 2-HAND CONTROL pushbuttons at the same time to automatically raise the rams.

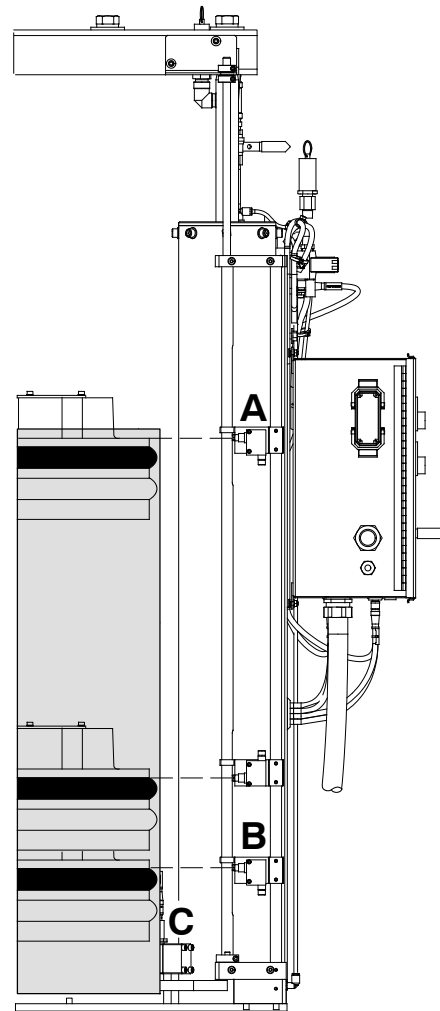

Figure 3 Using the Ram Controls

Daily Operation

1. See Figures 4 and 3. Lower the follower:
 - a. Make sure that the DRUM IN POSITION light (3) is on.
 - b. Select DOWN on the RAM DIRECTION switch (2).
 - c. Press the LEFT and RIGHT 2-HAND CONTROL push buttons (1) at the same time and hold in. Automatic ram movement will occur when the follower enters the drum and the Follower In Drum switch is enabled.
 - d. Release the push buttons.
2. Raise the follower:
 - a. Select UP on the RAM DIRECTION switch (2).
 - b. Momentarily press both push buttons (1) at the same time. The ram moves upward until it reaches the full-travel position.
3. When changing a material drum, press the PURGE push button when it is necessary to purge material from the inactive pump.

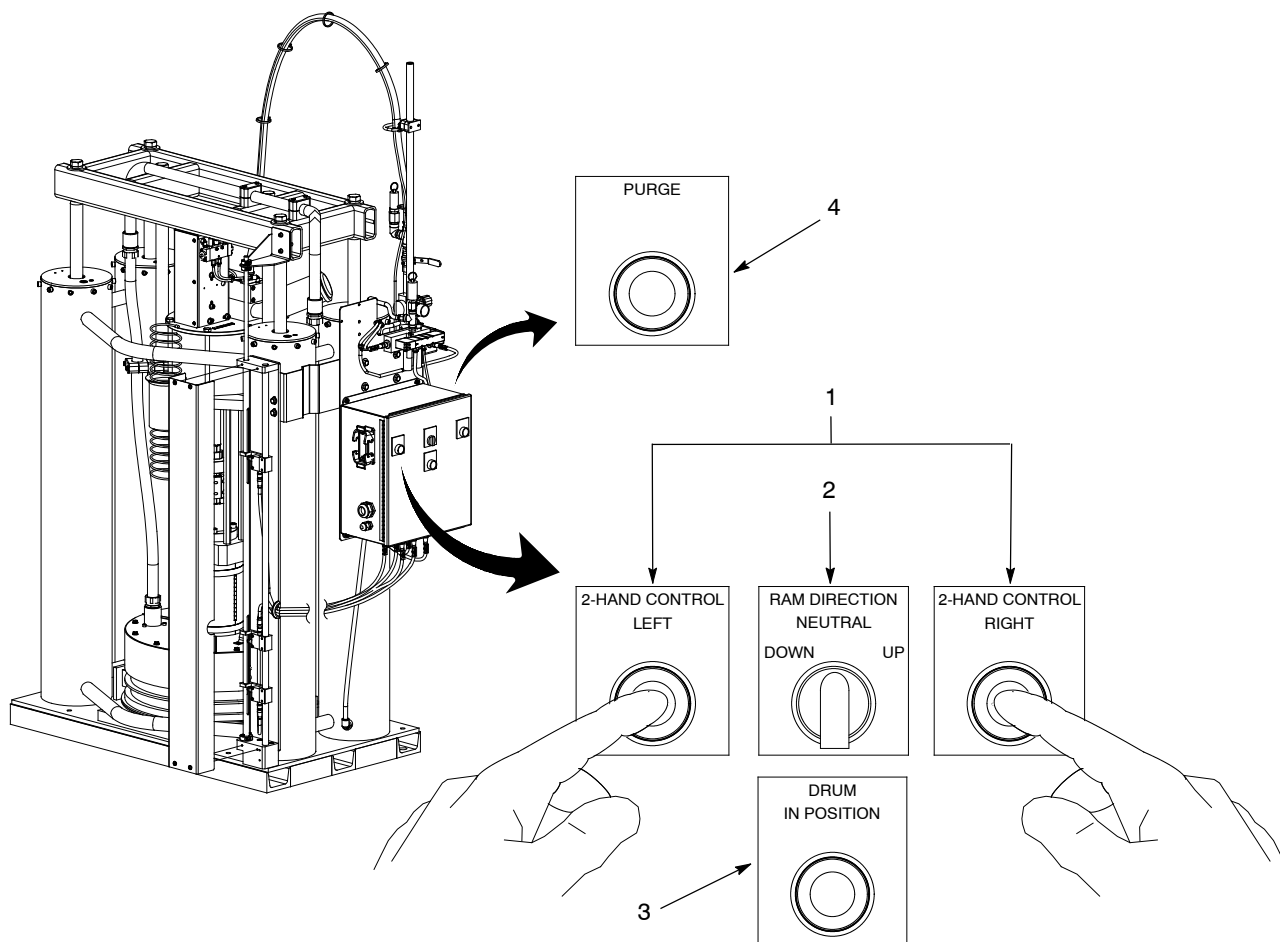

Figure 4 Operating the Controls

Using the Manual Mode for Service and Maintenance



CAUTION: If the follower needs to be lowered and a material drum is not positioned on the frame, place support blocks (2) on the frame base as shown in Figure 5 to prevent damage to the drum position sensor (1).

1. See Figure 4. Lower the follower:
 - a. Select DOWN on the RAM DIRECTION switch (2).
 - b. Press the LEFT and RIGHT 2-HAND CONTROL push buttons (1) at the same time and hold in. Release the push buttons to stop ram movement.
2. Raise the follower:
 - a. Select UP on the RAM DIRECTION switch (2).
 - b. Press the LEFT and RIGHT 2-HAND CONTROL push buttons (1) at the same time and hold in. Release the push buttons to stop ram movement.

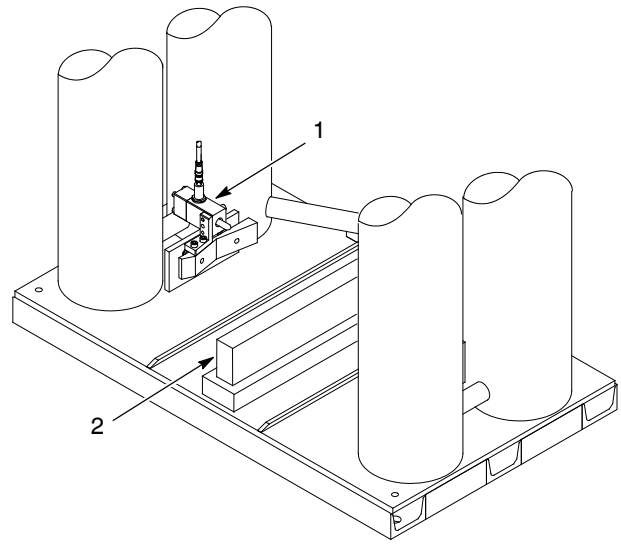

Figure 5 Drum Position Sensor

Parts

To order parts, call the Nordson Customer Service Center or your local Nordson representative. See Figure 6 and the following parts list.

Pneumatic Schematic

See Figure 7.

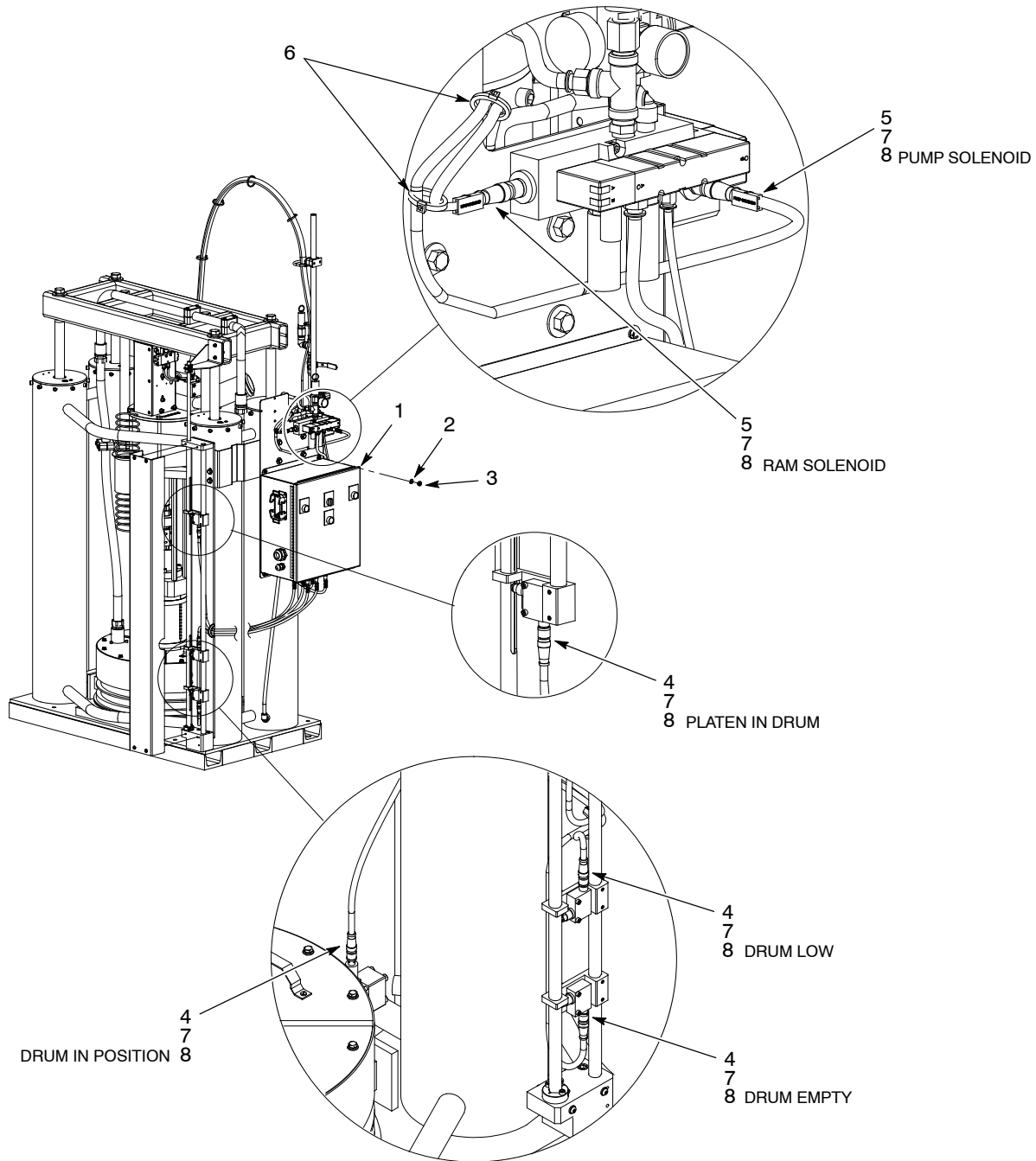

Figure 6 Two-Hand Control J-Box Module Parts

Item	Part	Description	Quantity	Note
—	1088690	Module, J-Box, Rhino XD2H, 4-Post frame	1	
1	1086621	• Junction box, Rhino XD2H, 2-hand, CE	1	
2	983409	• Washer, lock, M6	4	
3	984703	• Nut, hex, M6	4	
4	1046023	• Cable assembly, 4 conductor, 1 m, male/fem, 18 AWG, 250V	4	
5	1044427	• Cable assembly, 4 conductor, 2 m, male/fem, 18 AWG, 250V	2	
6	324289	• Strap, cable, 0.06–4.00, black	12	
7	939004	• Strap, cable, 0.06–1.75, natural, 12260–4	12	
8	1082631	• Kit, label, cable, J-box, Rhino XD2	1	

Contact Us

Nordson Corporation welcomes requests for information, comments, and inquiries about its products. General information about Nordson can be found on the Internet using the following address:
<http://www.nordson.com>.

Address all correspondence to:

Nordson Corporation
 Attn: Customer Service
 555 Jackson Street
 Amherst, OH 44001

Notice

This is a Nordson Corporation publication which is protected by copyright. Original copyright date 2008. No part of this document may be photocopied, reproduced, or translated to another language without the prior written consent of Nordson Corporation. The information contained in this publication is subject to change without notice.

Trademarks

Nordson, the Nordson logo, and Rhino are registered trademarks of Nordson Corporation.

All other trademarks are the property of their respective owners.

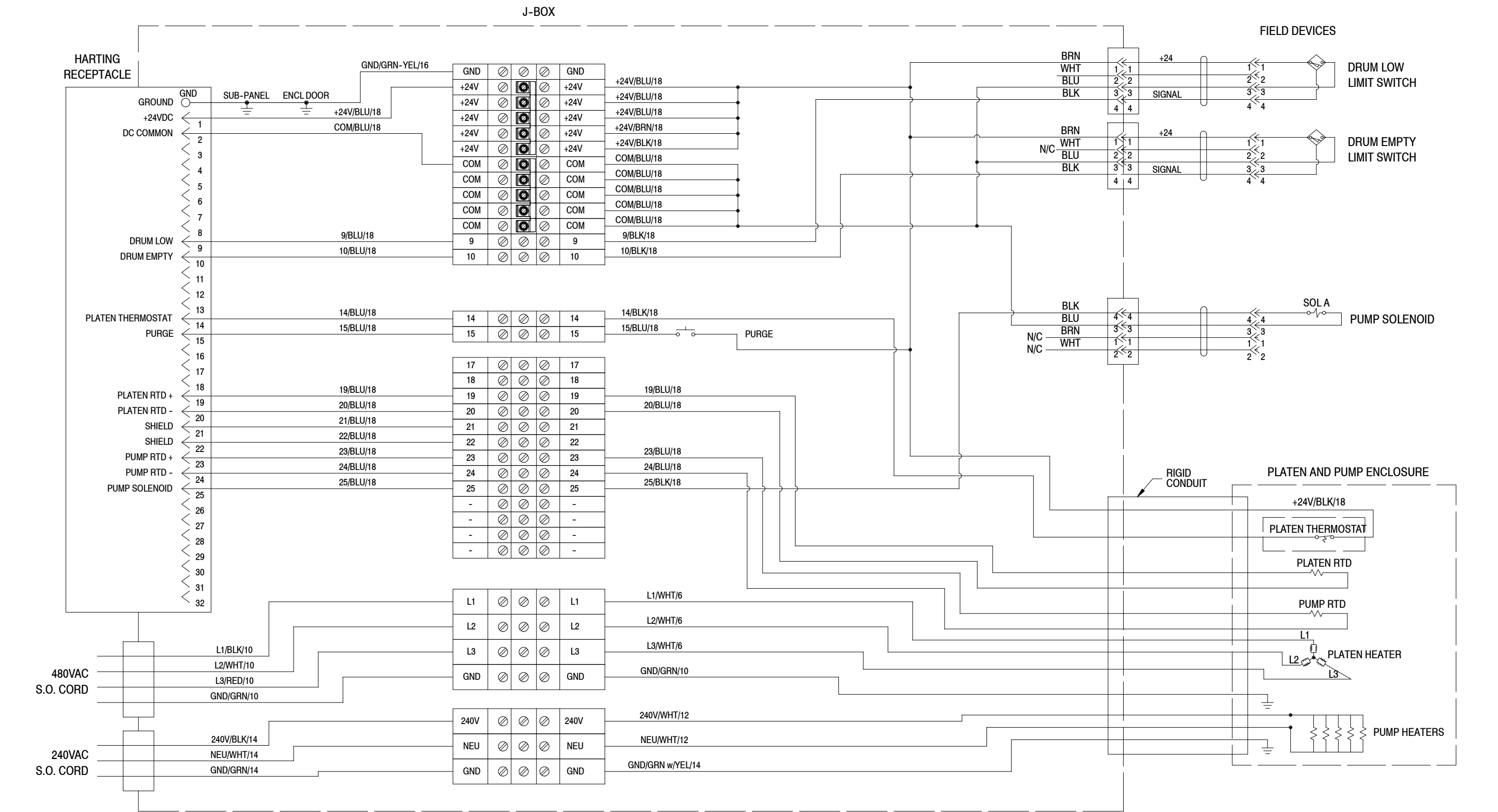

Figure 7 Pneumatic Schematic