

## Description

See Figure 1. The Rhino SD2/XD2 Drive Train Shroud (1) prevents access to the following pinch-point components during pump operation:

- Air Motor Piston Rod
- Hydraulic Section Plunger Rod
- Solvent Cup

## Installation

Install the Drive Train Shroud as shown in Figure 1. Tighten the band clamps (2) securely.

## Parts

Call the Nordson Customer Service Center or a local Nordson representative. Use this part number to order a Drive Train Shroud: 1082394

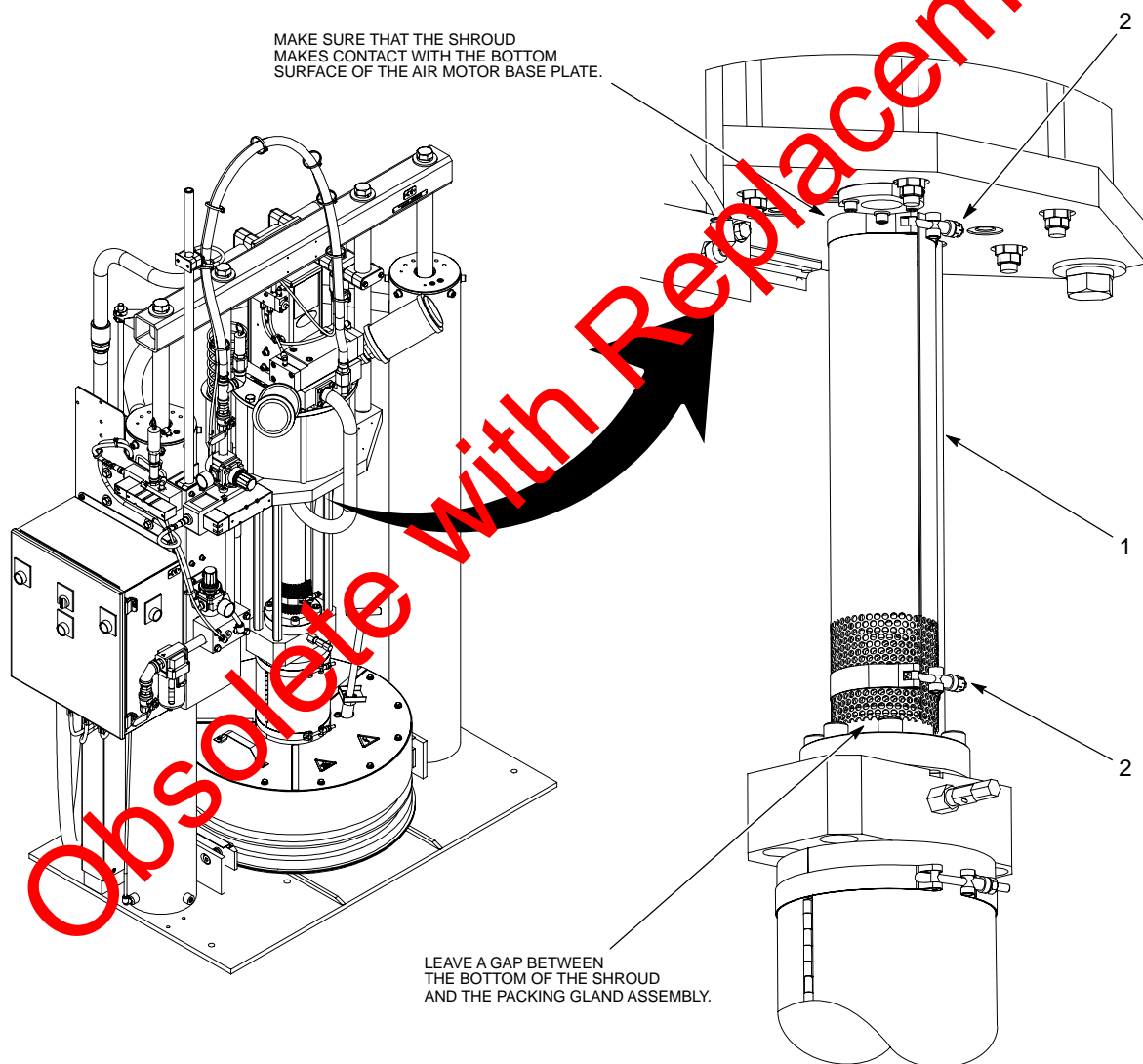

Figure 1 Rhino SD2/XD2 Drive Train Shroud

## Notes:

Complete with Replacement

**Contact Us**

Nordson Corporation welcomes requests for information, comments, and inquiries about its products. General information about Nordson can be found on the Internet using the following address:  
<http://www.nordson.com>.

Address all correspondence to:

Nordson Corporation  
Attn: Customer Service  
555 Jackson Street  
Amherst, OH 44001

## Notice

This is a Nordson Corporation publication which is protected by copyright. Original copyright date 2008. No part of this document may be photocopied, reproduced, or translated to another language without the prior written consent of Nordson Corporation. The information contained in this publication is subject to change without notice.

## Trademarks

Nordson, the Nordson logo, and Rhino are registered trademarks of Nordson Corporation.

All other trademarks are the property of their respective owners.