



**WARNING:** Allow only qualified personnel to perform the following tasks. Follow the safety instructions in this document and all other related documentation.

Severe personal injury could result if hands or fingers are caught between the follower plate and container. Keep hands clear of this area.

Do not open the bleed valve (7) more than three turns. The bleed valve and material may be forced from the valve body.

**NOTE:** Refer to the unloader controls manual for detailed operation information.

See Figure 1. The unloader shown in Figure 1 may have additional options. These procedures include steps for the blow-off option and container hold-down option. Contact a Nordson representative with any questions.

1. Set the air motor lockout valve (1) to *Off*.
2. Place the elevator control valve (4) in *Neutral*.
3. Open the blow-off valve (7).
4. Place the elevator control valve (4) in *Up*. If the container begins to rise off the unloader frame, place the elevator control valve in *Neutral* to allow the container to return to the frame. Then, place the elevator control valve in *Up*.
5. Raise the elevator until it reaches its maximum height, clear of the container.
6. Close the blow-off valve (7).
7. Unlatch the hold-down if used, and remove the old container. Center a new, undamaged container under the follower plate. If used, latch the hold-down.
8. Coat the follower plate seals (5) with a compatible lubricant, if required.
9. Remove the bleeder stem (6).
10. Place the elevator control valve (4) in *Down* to lower the follower plate into the container.
11. Allow air to bleed from the bleeder stem (6) fitting as follower moves downward. When material starts to continuously flow from the bleeder stem fitting, place the elevator control valve (4) in *Neutral*.
12. Install the bleeder stem (6).

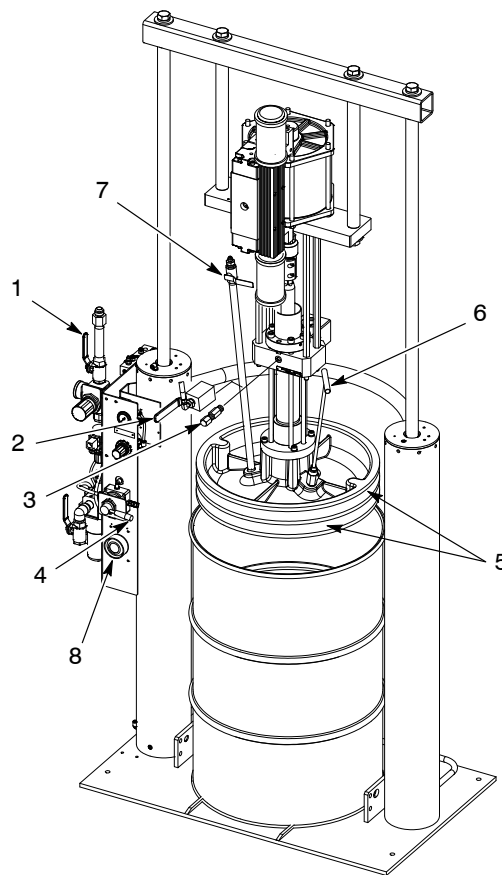

Figure 1 Rhino SD/XD Container Change

**NOTE:** Use image for reference only.

13. Place the elevator control valve (4) in *Down* to apply downward force to the elevator.
14. Set the air motor lockout valve (1) to on.
15. Depending upon your system, perform one of the following using minimal pump air pressure:
 

**NOTE:** Small-frame Pail Units: The ball valve (2) or bleed valve (3) is located on the back of the pump.

  - Bleed the remaining air through the ball valve (2) and dispense guns.

**OR**

  - Open the bleed valve (3) no more than three turns. Bleed the remaining air through the bleed valve and dispense guns.
16. Press the purge button (8) to cycle the pump.
17. After all air is bled, close the ball valve (2) or the bleed valve (3).

Issued 3/18

Original copyright date 2003. Nordson, the Nordson logo, and Rhino are registered trademarks of Nordson Corporation.