



WARNING: Allow only qualified personnel to perform the following tasks. Follow the safety instructions in this document and all other related documentation.

This procedure requires the following components that are not included in this kit:

- Guide tool, part 1025060
- Shield liner, part 1016956

Remove the Motor Rotor Assembly

1. See Figure 1. Remove the button-head screws securing the rotary shield to the motor.
2. Remove the swirl cartridge retainer, swirl cartridge, and swirl cartridge wave spring from the motor.
3. Remove the swirl bearing retainer using the spanner wrench supplied with the applicator. Discard the swirl bearing retainer.
4. Insert the guide tool into the motor. Install the swirl cartridge retainer and tighten securely.

Install the New Motor Rotor Assembly

NOTE: Perform the following steps with the motor rotor assembly facing up.

1. See Figure 1. Remove and save the socket-head cap screws securing the motor rotor plate to the motor. Pull the motor rotor assembly out of the motor.
2. Make sure that the wave spring is properly positioned in the housing. Insert the new motor rotor assembly into the motor. The motor rotor assembly should make contact with the wave spring.
3. Apply Loctite® 242 to the threads of the socket-head cap screws. Install the motor rotor retaining plate using the socket-head cap screws. Tighten the socket-head cap screws to 5–7 in-lb. (0.5–0.8 N•m).
4. Remove the swirl cartridge retainer and guide from the motor.
5. Install a new swirl bearing retainer using the spanner wrench supplied with the applicator. Tighten to 20 ft lb. (27 N•m).
6. Make sure that the swirl cartridge wave spring is installed on top of the swirl cartridge. Insert the swirl cartridge into the motor and push firmly until it snaps into place.
7. Install the swirl cartridge retainer and tighten securely.

8. Install the rotary shield to the motor using the button-head screws. Tighten the button-head screws securely.
9. Pull the two tabs on the lip of the shield liner and remove it from the rotary shield.
10. Press a new shield liner onto the rotary shield with the palm of your hand.

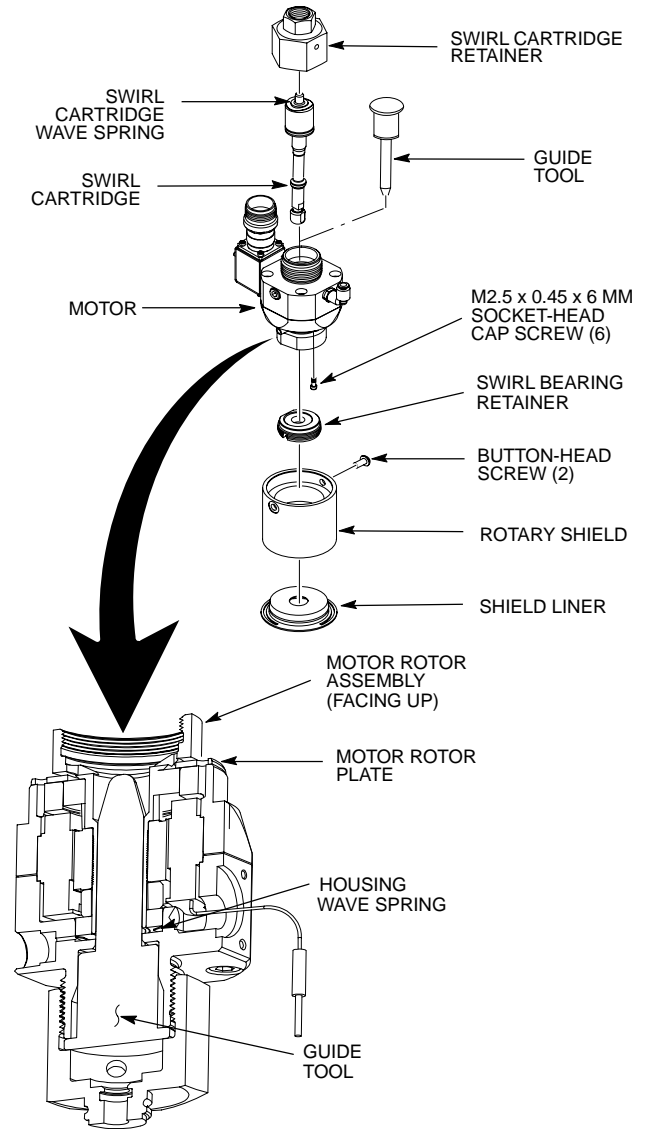

Figure 1 Motor Rotor Replacement

Parts

Part	Description
1041571	Kit, motor rotor, Pro-Swirl
-----	• Motor rotor assembly