

Pro-Swirl Teach Tip Installation



WARNING: Allow only qualified personnel to perform the following tasks. Follow the safety instructions in this document and all other related documentation.

Installation

Use the following procedure to install a teach tip to a Pro-Swirl applicator.

1. See Figure 1. Relieve fluid and air pressures from the applicator (3).
2. Place the teach tip O-ring (5) onto the teach tip (7). Make sure that the O-ring is about 2.54 cm (1 in.) from the end.
3. Install the teach tip into the teach tip holder (4) until it bottoms out. The O-ring should be against the face of the teach tip holder.
4. Using the nut (6), secure the teach tip to the teach tip holder. Hand-tighten the nut.
5. Remove the button-head screws (1) and the rotary shield and shield liner (2) from the applicator (3).

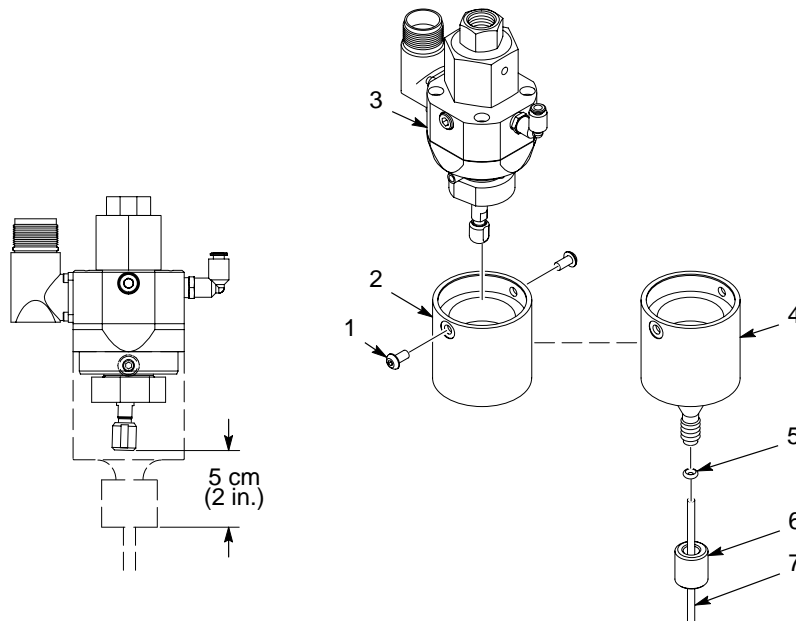

1100056A

Figure 1 Teach Tip Installation

- | | | |
|-----------------------------------|---------------------|--------------|
| 1. Button-head screws | 4. Teach tip holder | 7. Teach tip |
| 2. Rotary shield and shield liner | 5. Teach tip O-ring | |
| 3. Applicator | 6. Teach tip nut | |

Installation *(contd)*

6. Install the assembled teach tip on the applicator with the screws.

NOTE: The distance from the bottom face of the teach tip nut to the face of the nozzle is 5.08 cm (2 in.).

7. Cut the teach tip to the desired length using a wire cutter, taking into account the 5.08 cm (2 in.) distance from the bottom face of the teach tip nut to the face of the nozzle.
8. When you are finished programming the applicator path, remove the teach tip and replace it with the rotary shield and shield liner.

Parts

Use the following part number to order additional kits:

Part	Description
1018166	Teach tip, Pro-Swirl

Issued 2/02

Original copyright date 2002. Nordson and the Nordson logo are registered trademarks of Nordson Corporation.