

Center Mount Cartridge Filters

Installation Guide for Nordson High-Efficiency, Heavy Duty, and PowderGrid® Filters

Procedure



WARNING: Allow only qualified personnel to perform the following tasks. Follow the safety instructions in this document and all other related documentation.

1. Remove and properly dispose of the old cartridge filters. Refer to your powder coating system manual for removal procedures.

NOTE: Keep all of the hardware to install the new cartridge filter.

2. Clean the sealing surface on the underside of the mounting plates.

NOTE: Do not install damaged cartridge filters. If the filter was damaged during shipment, contact the freight carrier. Otherwise, contact your Nordson representative.

3. Inspect each new cartridge filter for damage including:

- Nicks or cuts in the rubber gasket
- Tears or holes in the filter media
- Bent or dented end caps
- Dented screens

4. See Figure 1. Set the centering bracket (1) into the open end of the new cartridge filter.



CAUTION: Do not overtighten the draw rod. Filter damage may occur.

5. Slide the new draw rod (2) through the centering bracket and screw the draw rod into the bottom of the cartridge filter. Tighten by hand.
6. Center the cartridge filter under the opening in the mounting plate. Reach down through the mounting plate opening and use the T-handle on the draw rod to lift the cartridge filter against the mounting plate.
7. Install the tripod (3) on the the draw rod, making sure the slots in the mounting bracket slip over the T-handle.
8. Install the flat washer (4) , lock washer (5), and nut (6) on the draw rod. Do not tighten the nut at this time.
9. Slip the ends of the tripod into the locating slots around the filter opening in the mounting plate.



CAUTION: Do not overtighten the nut. Filter or tripod damage may occur.

10. Tighten the nut until the mounting plate and the centering brackets are touching. They will compress the filter gasket and seal the cartridge against the mounting plate.
11. Check the alignment of the cartridges and use a feeler gauge to check the gasket compression.

Parts

See Figure 1.

Item	Part	Description	Quantity
1	174722	BRACKET, centering	1
2	174724	26-in. DRAW ROD, filter mount	1
2	176278	32-in. DRAW ROD, filter mount	1
2	174723	36-in. DRAW ROD, filter mount	1
3	174720	TRIPOD, cartridge mount, Excel series	1
3	179215	TRIPOD cartridge mount, 500 series	1
4	983090	WASHER, flat, $\frac{5}{8}$ in.	1
5	983440	LOCK WASHER, $\frac{5}{8}$ in.	1
6	984178	NUT, hex, $\frac{5}{8}$ -11	1

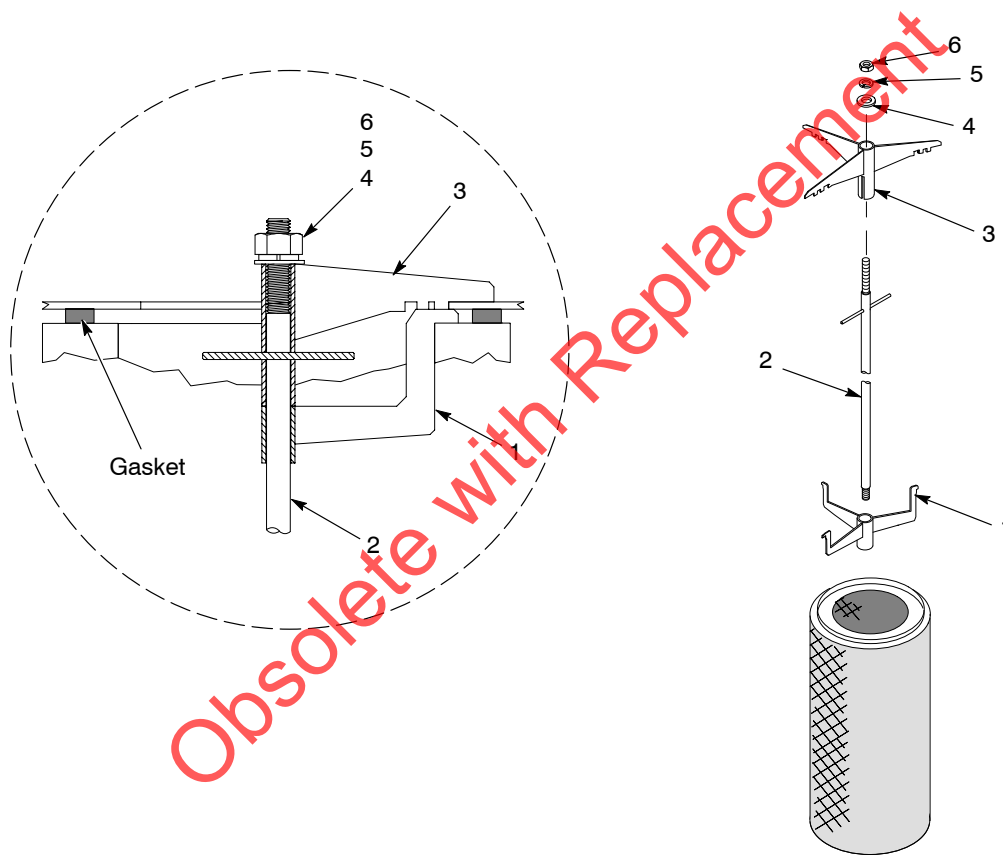

1401129B

Figure 1 Center Mount Cartridge Filters

Issued 2/04

Original copyright date 2003. Nordson, the Nordson logo, and PowderGrid are registered trademarks of Nordson Corporation.