

Manifold Replacement Kit - PNs 1064651, 1064652, 1064653, and 1064654

Use this kit to replace the manifold assembly, which includes the heater block and the pressure discharge valve, on a ProBlue[®] adhesive melter.

WARNING: Risk of personal injury or equipment damage! Refer to the safety information provided in the melter manual before servicing the melter. Failure to comply with the safety information provided can result in personal injury, including death.

Required Tools:
 4-mm hex wrench
 6-mm hex wrench
 5/16 in. open-end wrench (2 required)

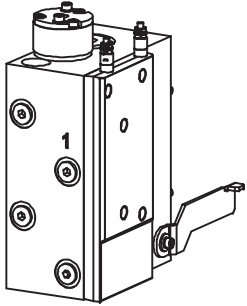

Manifold assembly (complete)
(P4 manifold shown)



O-rings:
 P/N 1019515 (2)
 P/N 942111 (1)
 P/N 1106992 (2)
 P/N 940133 (2)

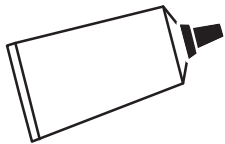

Parker Lubricant

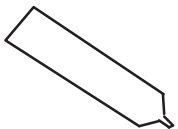

Heatsink compound
(PN 1124470)

Prepare the Melter

1. Operate the melter, discharging hot melt until the tank is empty.

Note: Reduce the speed of the pump to fully empty the tank.

2. Relieve the system hydraulic pressure. Refer to the melter product manual for information about relieving hydraulic pressure.

3. Disconnect all hoses from the manifold.

WARNING: Risk of electrocution! The manifold heater terminals carry high voltage. Before removing the back panel, ensure that power to the melter is disconnected at the local power disconnect. Failure to properly disconnect power from the melter can result in personal injury, including death.

4. Switch the melter off.

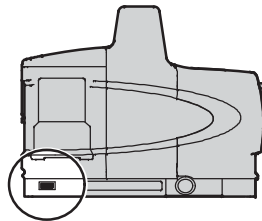

5. Disconnect power to the melter at the local power disconnect switch.

6. Open the filter access door, and then remove the top panel, the air filter, and the back panel.

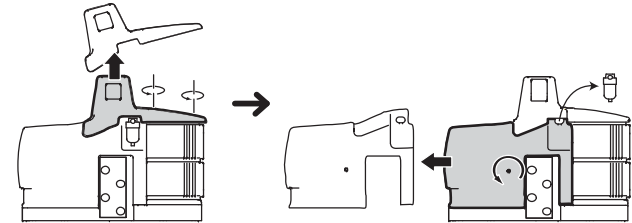

Panel Removal - P4/7/10

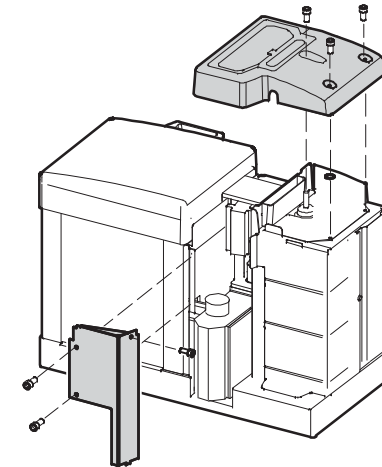

Panel Removal - P15/30/50

Continue



Remove the Pump and the RTD

1. Remove the pump as follows (P4 melter shown):

a. Rotate the handle of the isolation valve upward until it is vertical.

b. Remove the three pump-mounting bolts.

c. While pulling the pump away from the manifold, tilt the top of the pump toward the front of the melter and then remove the air line(s) from the back of the pump.

d. Lift the pump clear of the melter.

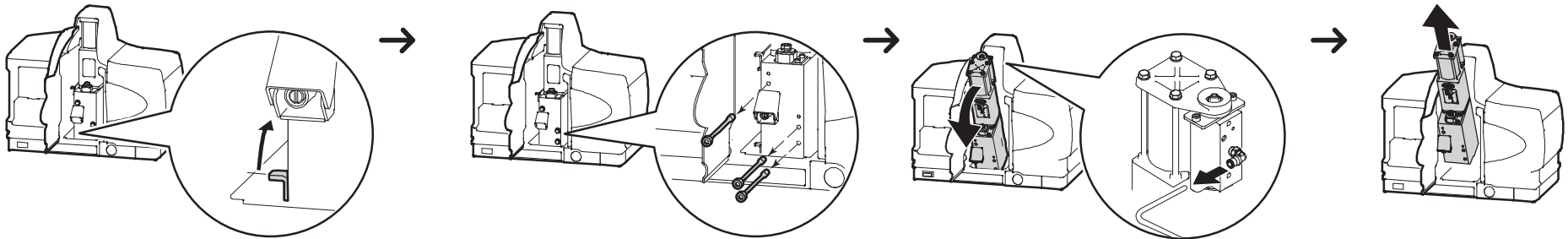

Note: To gain leverage when removing the pump, thread long M6 bolts into the two threaded holes located on the face of the pump body.

2. Remove RTD from the back of the manifold.

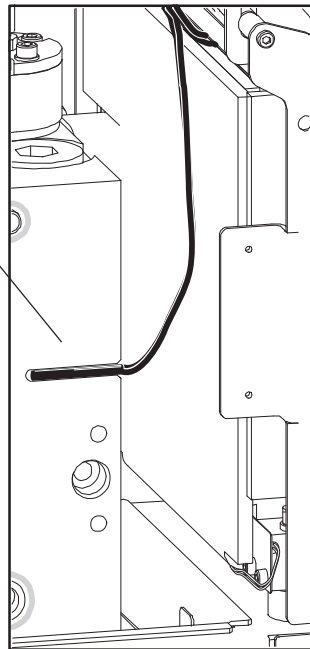

Continue



Remove the Manifold

It is necessary to shift the electrical enclosure (not remove) to gain access to the all of the screws that secure the heater-block to the manifold.

1. Remove the four nuts from the threaded posts that protrude up through the base of the electrical enclosure. Two of the posts are located just inside the electrical enclosure, and the remaining two posts are located at the back of the melter, just below the hose/gun modules. See the illustration below.

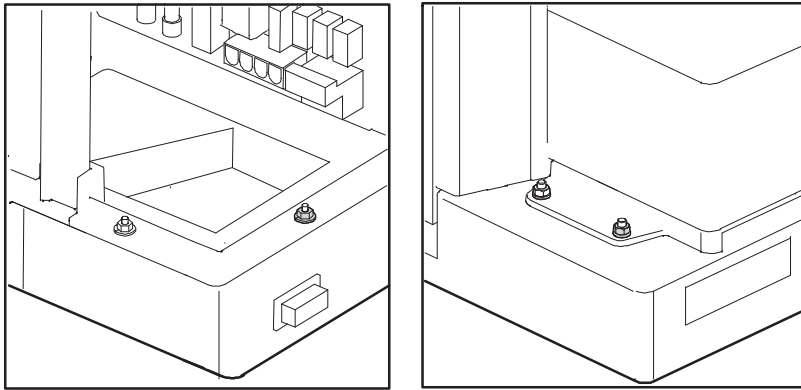

2. Remove the input air fitting, and then separate the cross-bracket from the electrical enclosure.

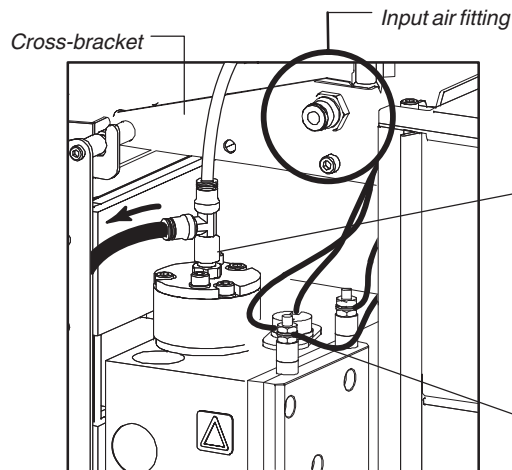

3. Lift, and then shift the enclosure away from the manifold.

4. Disconnect the air line from the pressure discharge valve.

CAUTION: Use two wrenches, one on each terminal nut, when disconnecting the heater terminals. Using only one wrench can result in damage to the heater.

5. Disconnect the leads from the heater terminals and the thermostat.

6. Do one of the following:

If an heater-block is already installed - Remove the five M5 screws and lock washers, and then remove the heater block from the manifold.

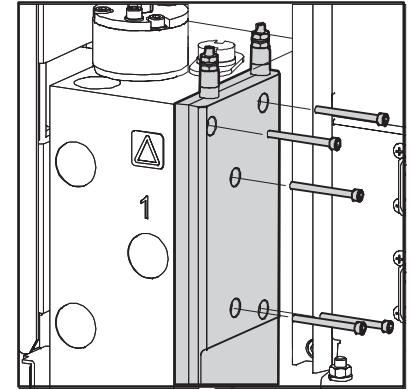

If a U-shaped heater is installed- Remove and discard the two M5 screws and lockwashers, and then remove and discard the backup plate and the insulator plate.

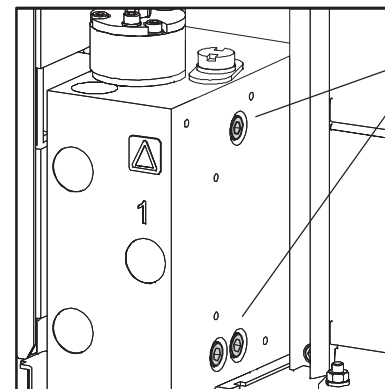
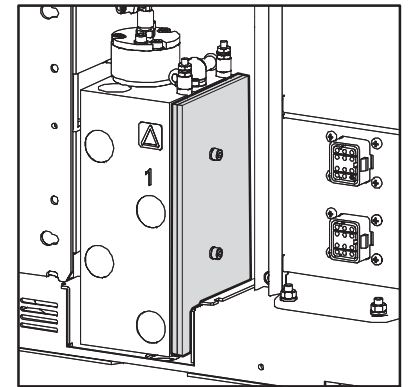

7. Loosen, and then partially remove the three M8 screws that attach the manifold to the tank.

Note: Save the screws and do not wipe off the Never-Seez compound from the screw threads.

Continue



Install the New Manifold Assembly

1. Separate the new heater-block and manifold by removing the five M5 screws.

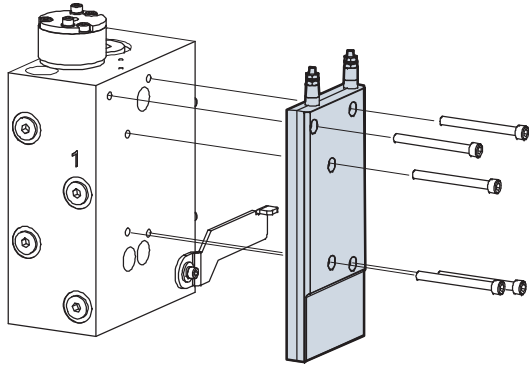

2. Lubricate O-rings PN 1019515 (2), 942111 (1), 1106992 (2), and 940133 (2) with Parker Lubricant, and install each O-ring into the new manifold.

Attention:

This kit contains a heatsink compound that can cause skin and eye irritation. The Material Safety Data Sheet (MSDS) for this material may be obtained by contacting the manufacturer Aremco Products, Inc. 845-268-0039 or www.aremco.com.

3. Apply heat sink compound (provided in the kit) to the face of the heater block. Spread the compound out to evenly coat the entire contact surface between the manifold and the heater-block.
4. Install the new manifold and the heater-block by reversing the sequence of steps described in *Remove the Manifold*.

Note: When installing the heater block, tighten the M5 screws to .6-.8 Nm (5-7 in-lb).

5. Reinstall the pump by reversing the sequence of steps described in *Remove the Pump*.

6. Replace the melter exterior panels and the air filter/line, restore power to the melter; and then switch the melter on.

